



MS-200™ Installation Guide

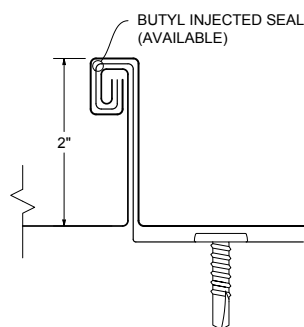
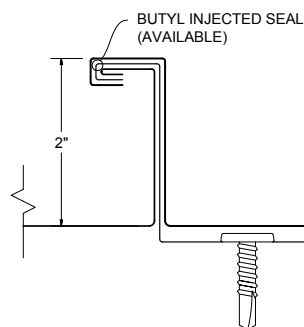
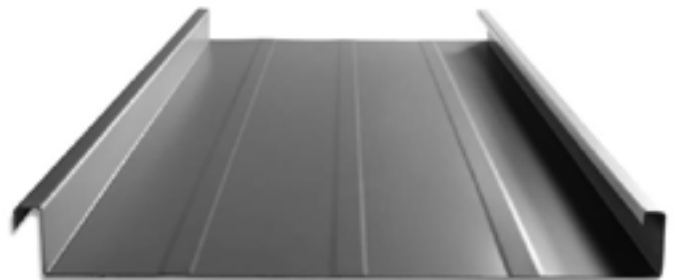
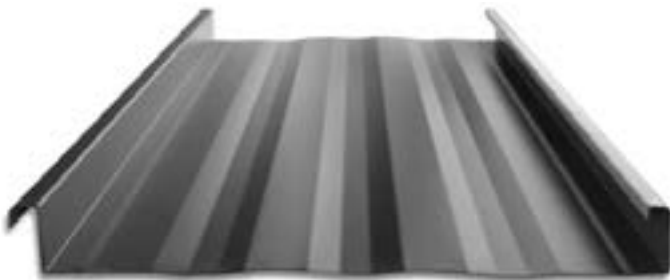



Table of Contents

Panel Specifications	2-3
Floating Panel Clip	4
Notes To Designer/Installer	5-7
Taylor Delivery Fleet	8
Delivery, Will Call & Loading	9
Standard Eave	10
Hook Eave	11
Gutter/Hook Eave	12
Standard Ridge	13
Vented Ridge	14
End Dam Attachment	15
Valley Flashing	16
Valley Flashing – Low Pitch	17
Standard Gable	18
Alternate Gable	19
Sidewall	20
Peak Flashing (R.E.C.)	21
Vented Peak Flashing (R.E.C.)	22
Pitch Change	23
Endwall	24
Vented Endwall	25
Saw Cut Endwall	26
Back Pan	27-29
Curb Side Wall	30
Curb End Wall	31
Curb/Pan Cricket	32
Eave to Gable Transition	33-35
Pipe Penetration – on Plate	36
Pipe Penetration – on Rib	37-38
Pipe Penetration – on Pan	39
Flashing Selection	40-44



KEY FEATURES

- 12", 14", 16" & 18" options available
- 24 & 22 gauge Tru-Gauge™ and .032" Aluminum
- Floating clip system: allows for expansion/contraction of panels in longer lengths
- 2" Mechanical seam rib, 90° or 180°: Factory notching available
- Factory injected Butyl sealant
- Structural panel that will span up to 5'
- Concealed fasteners: fasteners cannot leak
- Manufactured in Riverside CA, Sacramento CA & Salem OR
-  ICC-ESR #5046 with CBC-CRC Supplement
- FM Global Class #4471 Approved
-  - Code compliance UL Evaluation Report UL ER 25913-01
- UL Construction No. 90, 176, 180, 238, 238 A-C, 435, 435 A, 437, 449, 451, 452, 487, 506, & 506 A-C
- UL 580 Class 90 Wind Uplift, UL 790 Class A Fire rated and UL 2218 Class 4 Impact (hail) rated
- Dade PA 201-94 Class 90 Impact, 140 MPH Wind Uplift
- FM I-75 (60" o.c.)
FM I-120 (24" o.c.)
- ASTM E283 - Air infiltration (walls)
ASTM E331 - Water infiltration (walls)
ASTM E1592 - Structural uniform static air pressure
ASTM E1646 - Water infiltration (roof)
ASTM E1680 - Air infiltration (roof)
ASTM E2140 - Water test for full immersion hydrostatic roof systems
- Weather tightness warranty available
(Contact TMP representative for details)
- 1/2:12 minimum pitch recommended
(For lower pitches, please inquire)
- Standard panel lengths 5' to 60' - not notched
Standard panel lengths 1' to 60' - notched
(For longer panel lengths, please inquire)
- On-site roll forming available for long lengths
- Panel options: Striations, Accent Ribs, and Flat Pan
- Retro-fit systems available



PANEL PROFILES



ICC-ESR #5046

12", 14", 16" & 18" coverage options

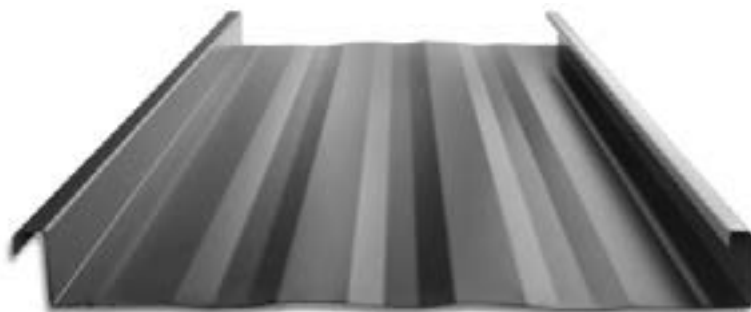

STRIATIONS

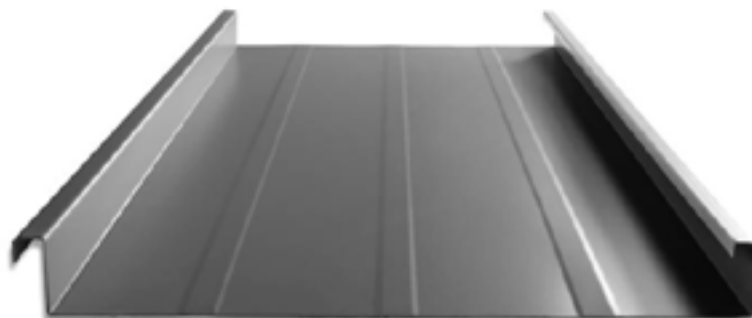

ACCENT RIBS 2 Accent ribs for 12" & 14" panel
3 Accent ribs for 16" & 18" panel

90° SEAM DETAIL

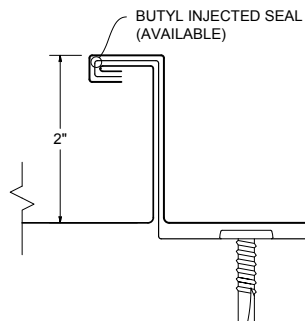

180° SEAM DETAIL

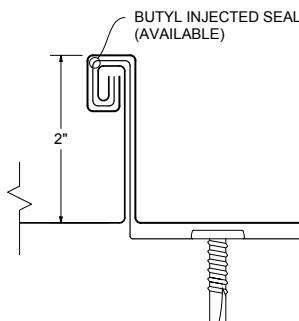

180 degree seams are not considered an architectural detail. The detail improves the weather tightness and wind uplift capabilities of the panel system, but will show stress and waviness in the seam. The detail is recommended for slopes less than 2:12, roof areas not easily viewed from the ground, and for high wind areas. For additional information, contact a TMP representative and DI Seamers for support and information about the proper use of seaming tools.

MATERIAL SPECIFICATIONS

- 24 gauge Kynar 500® Painted Steel
.0236" (Thickness prior to painting)
G-90 Galvanized or AZ-50
- 24 gauge bare Zinalume® Plus AZ-55
(No finish warranty – 25 yr. perforation warranty)
- ▲ 22 gauge Kynar 500® Painted Steel
.029" (Thickness prior to painting)
- ♦ .032" Kynar 500® Painted Aluminum
- 22 gauge Rusteel Plus™ (A606)
- 16 and 20 ounce Copper
(Please inquire)
- Kynar 500® and substrate testing data available
(See website)
- "Oil canning" is an inherent characteristic of roof and wall products, and not a defect, which is not a cause for panel rejection

KEY FEATURES

- 21 Standard Colors, 5 Metallic Colors and 4 Specialized Materials
- Kynar 500® Paint System - the ultimate in exterior durability and color retention
- "Cool" color pigments are specially designed to reflect infrared light, reducing heat gain to dwelling, and conform with ENERGY STAR® criteria
- Superior Quality, two coat, 70% resin finish, applied at a 1 mil. thickness
- 40 year residential paint warranty
- 20 and 30 year commercial paint warranty: Contact TMP for warranty specifications

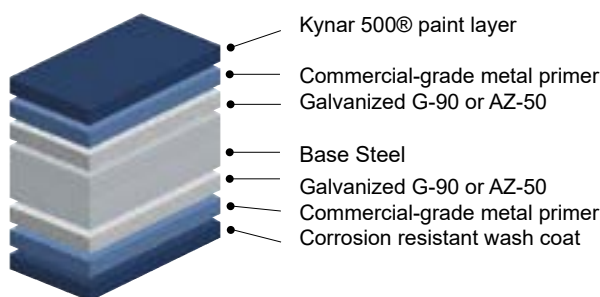

40-Year Residential / 20 and 30 Year Commercial Manufacturer's Limited Warranty

STANDARD COOL KYNAR 500® COLORS

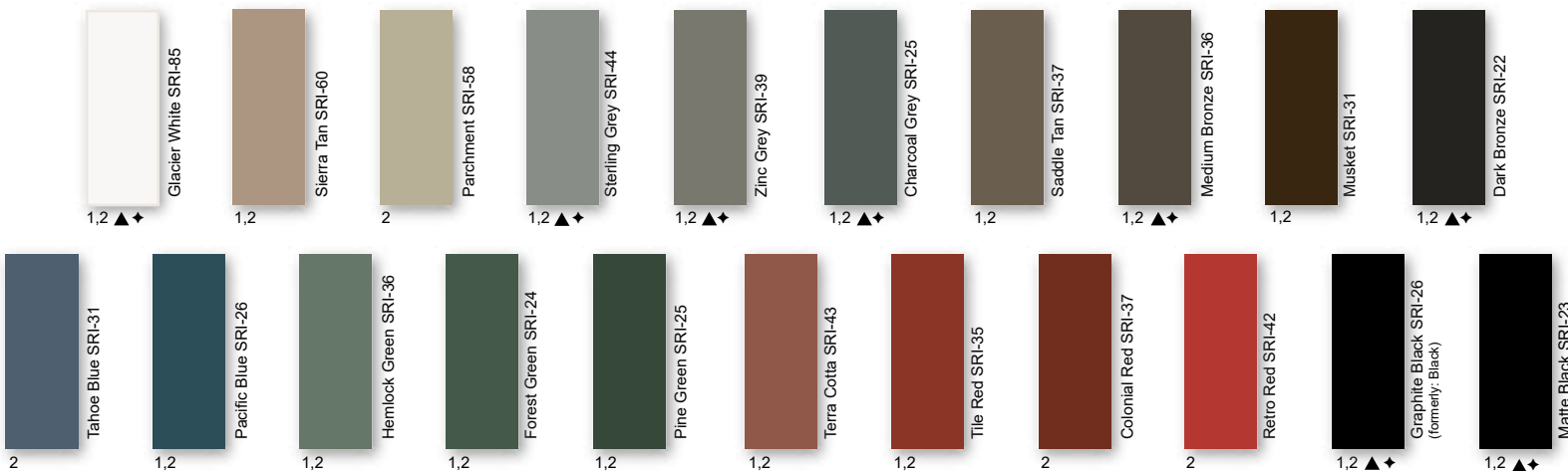

PREMIUM METALLIC COOL KYNAR® COLORS

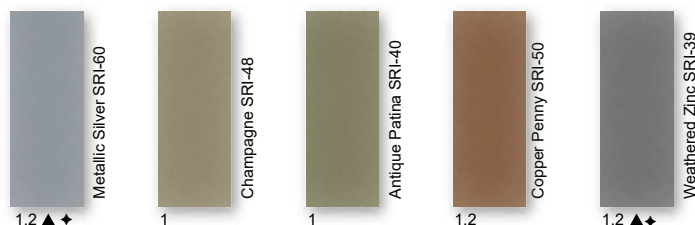

SPECIALIZED MATERIAL

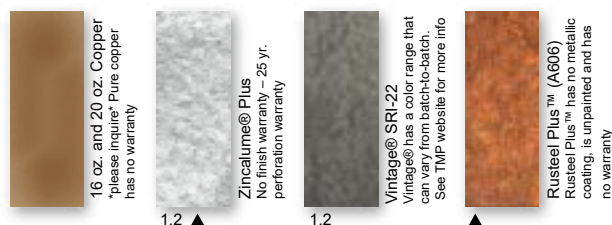

These printed chips provide a close representation of the colors.

Metal samples are available upon request. Coatings are low gloss 10-15% sheen.
SRI = Solar Reflective Index. SRI values listed above are in accordance with ASTM E 1980 and are based on actual testing. ***Oil canning is not a cause for material rejection***

Standard Panels				
Width	Gauge	Color	LBS SQFT	LBS LF
14-5/8"	24	1	1.36	1.65
18"	24	2	1.28	1.93
18"	22	▲	1.61	2.42
15-3/8"	.032 Alum	♦	0.6	0.9



**Taylor Metal Products
MS-200™ - UL 90 Floating Clip
18 ga. Base/22 ga. Top**



**UL 580 Class 90 Wind Uplift Rated
UL Class A Fire Rated**

Notes to Designer/Installer

Taylor Metal Products is providing the following details as an aid in design. The details in this guide are not inclusive to all design situations. The designer/installer is responsible for modifications and should take into consideration all aspects of the project including climate conditions, such as, snow and wind, as well as, building code requirements, building design, building usage and maintenance requirements.

Installation should be performed only by qualified installers familiar with metal roofing systems and industry standards. For details not shown in this guide, refer to the Sheet Metal and Air Conditioning Contractors National Association (SMACNA) architectural sheet metal manual for proper design. For manufacturer's weather tightness warranties – all details must be preapproved by Taylor Metal Products technical representative.

The Standard gauge for all products in this guide is 24 gauge and the standard finish is Kynar 500®. We recommend specifying all flashings be the same gauge, color, and finish as the panels to insure long-term durability and color match.

Substrates

Details in the manual are all shown over solid substrate. **MS-200™** can be used over spaced purlins. For solid substrate, **Taylor Metal Products** recommends 5/8" plywood or metal decking.

Underlayment

For roofs with pitches below 3:12, High Temp Ice and Water shield underlayment must be installed across the entire surface (projects with manufacturer's weathertightness warranties require the TMP private label product). For pitches steeper than (or equal to) 3:12, High Temp Ice and Water is necessary at all perimeter locations, eave, ridge, valley, hips, sidewall, endwall, prow and penetrations. The remaining of the roof's field areas can then be covered with approved synthetic felt. If local codes or specifications require a Class A fire rated assembly, Polystick XFR or Titanium FR (both products are distributed by TMP) must be installed over the entire roof with combustible decks.

Follow manufactures instructions carefully for all underlayment installation.

Drag Load Requirements

All panels must be pinned at one end to resist the drag load caused by snow loads, live loads, and the weight of the panel. Drag load is a function of roof slope, actual load and length of panels. Contact **Taylor Metal Products** for specific drag load requirements.

Ventilation/Insulation

It is the responsibility of the designer to determine the material types needed to control condensation and to insulate and ventilate the roof system. Applications over rigid insulation may require blocking for solid attachment and framing the perimeter for installation of perimeter flashings.

Oil Canning

Flat metal surfaces will display waviness commonly referred to as “oil canning.” Oil canning is caused by a variety of conditions. Steel mill tolerances, variations in or uneven substrates and roofing underlayments. Oil canning is a characteristic of metal roofing, not a defect and is not a cause for rejection. **Taylor Metal Products** offers **MS-200™** with striations or accent ribs to help minimize oil canning.

Thermal Movement

The Panels and the flashings must be allowed to expand and contract, especially with longer length panels. The panel may need to have a slight gap where the panel hooks the offset cleat to allow for thermal movement of the panels.

Snow Design

The following details do not address all conditions for snow environments. Consult with the designers, engineers, and others for acceptable details to accommodate your project and climate conditions. When possible gutters, valleys, pitch changes or other penetrations should be minimized in snow areas.

All roof penetrations should be located as close to the ridge or “pin point” top of roof. Snow country requires special designs for valleys to accommodate accumulation of snow and ice from uphill panels. Roof design should be considered in snow areas. Roof design should help resist the melting and freezing of snow and ice.

A fit for purpose roof design has the greatest impact on maintaining a damage free roof system in snow areas. Please contact a Taylor Metal Products representative for assistance in detail designs and appropriate panel selection for specific climate and building conditions.

Handling / Storage & Safety

Handle materials with care when off-loading or moving materials to avoid damage to panels or flashings. Long panels may require two or more pick-up points, properly spaced to avoid damaging panels. Plan ahead; contact Taylor Metal Products for recommendations on handling/hoisting long panels.

Store the panels, flashings and accessories in a dry, well ventilated area, off the ground. If covering, allow ventilation around panels. Elevate one end of bundle to allow drainage of wet materials.

Wear clean, soft-soled shoes when walking on roofing panels to avoid damage to the painted finish.

Take care that sand, gravel, dirt, etc. sticking to your shoes is not carried onto the roof, scratching or otherwise damaging the finish on the roofing material. Walking on asphalt impregnated felt paper, especially on a hot day, can cause the asphalt to stick to your shoes and be tracked on to the roofing material.

Take care when painting to avoid getting over spray on the roofing material. Remember that wind can carry paint particles some distance. Over spray can cause the finish of the roofing material to look dull and may void your warranty.

Secure materials, especially when leaving the site, on the ground or roof to prevent winds from moving the materials. Wind-blown materials may cause damage to the material, property or persons.

Always use proper safety equipment and attire to minimize risk of cuts or other injuries.

Do not walk on panels that have not been completely installed.

Do not walk on major ribs of panels.

Metal roofs that are wet or dusty can be extremely slippery. Wear soft soled shoes and a safety harness to minimize risk of falling.

Avoid installing metal panels in windy conditions.

Safety considerations are the responsibility of the installer and his crew. Be sure to and **use common sense** generally accepted safety practices when installing roofing materials.

Taylor Delivery Fleet



Delivery Fleet

Taylor Metal Products prides itself with quick lead times delivered with our fleet of semi trucks. Our fleet of trucks are owned and operated by TMP. All of our drivers are Taylor Metal Products employees, so when your truck rolls in to deliver, you are dealing with Taylor Metal Products.

Expect consistent and exceptional service with short leadtimes. The inhouse fleet allows for efficient and cost-effective delivery.



Mounted on the rear of our truck's trailer, the trailer-mounted "Piggy-Back" forklift will accompany you right to your place of use, opening up unprecedented possibilities in terms of transportation. It can travel sideways, carrying panels up to 40' long, allowing delivery in locations that would typically be considered impossible to reach.

Save time and effort while avoiding potential loading and transport issues; have experienced TMP personnel deliver and unload your order.



Delivery

We will make every attempt to deliver material to the desired location. We may be unable to gain access on tight corners or steep terrain. If the site is deemed inaccessible by our driver, the customer may choose an alternate delivery site within a reasonable proximity. If we are unable to make the delivery, additional charges may be assessed.

The customer is responsible for:

- Determining adequate access for delivery ahead of time.
- Meeting the delivery at the agreed upon time.
- Providing adequate resources (1-4 people as needed) for off loading materials.
- **A charge of \$100 per hour may be added for deliveries that go beyond their allotted time.**
- Checking the shipment at the time of delivery.
- Verifying material quantities against the shipping/packing list.
- Noting any damage or discrepancies upon the paper work at the time of delivery and notifying Taylor Metal Products within 48 hours of delivery.

Delivery times are usually scheduled one day in advance. Taylor Metal Products will make every effort to make the delivery at the scheduled time. Please be aware that there may be conditions beyond our control such as traffic, mechanical failures, road closures, etc. which may affect our schedule.

Will Call & Loading

Flatbed trailers and trucks are best suited to transport metal roofing materials. These can be loaded from the side with a forklift and tied down in a safe and secure manner.

We are not able to load materials onto vehicles and/or trailers which are not suitable or may be hazardous to load. Please be aware that if we find a vehicle to be inappropriate, we reserve the right to refuse to load your order.

Unacceptable examples include: boat trailers, vans, buses, motor homes, campers and box trailers. Pickup racks which do not have sufficient supports for the weight or are not long enough to support bundles are also unacceptable.

Taylor Metal Products is not responsible to tie down loads nor do we provide any tie down materials. Please bring tie downs to secure your load (string or twine are **not** acceptable for this purpose).

Consider having your order delivered on one of our trucks with a piggy back forklift.



Standard Eave

STANDARD EAVE DETAIL

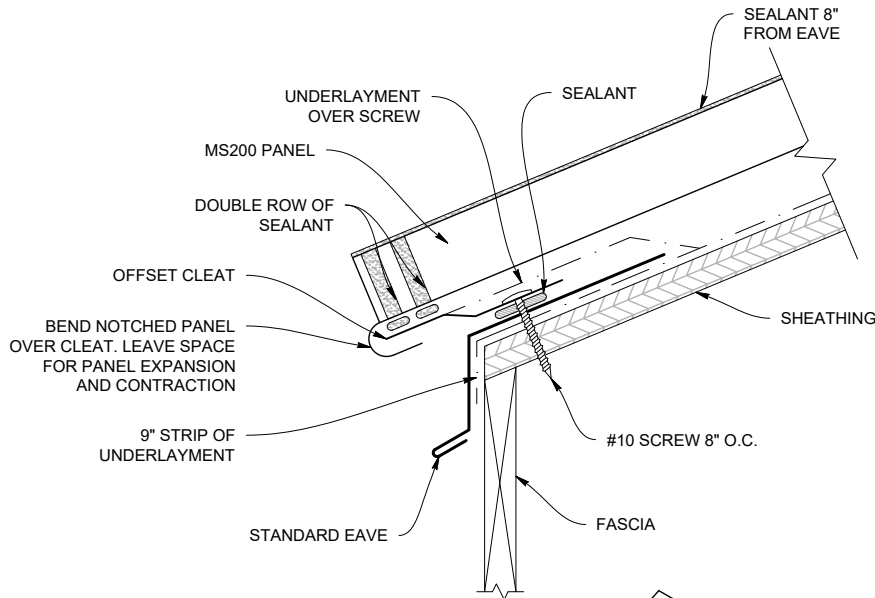

STANDARD EAVE (MS200ES)

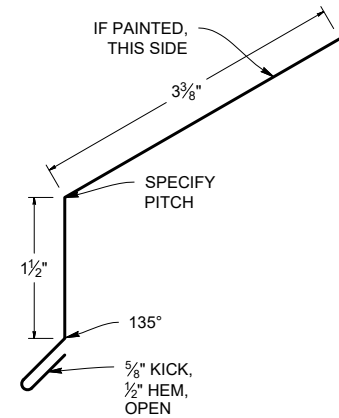

OFFSET CLEAT (MS200OC)

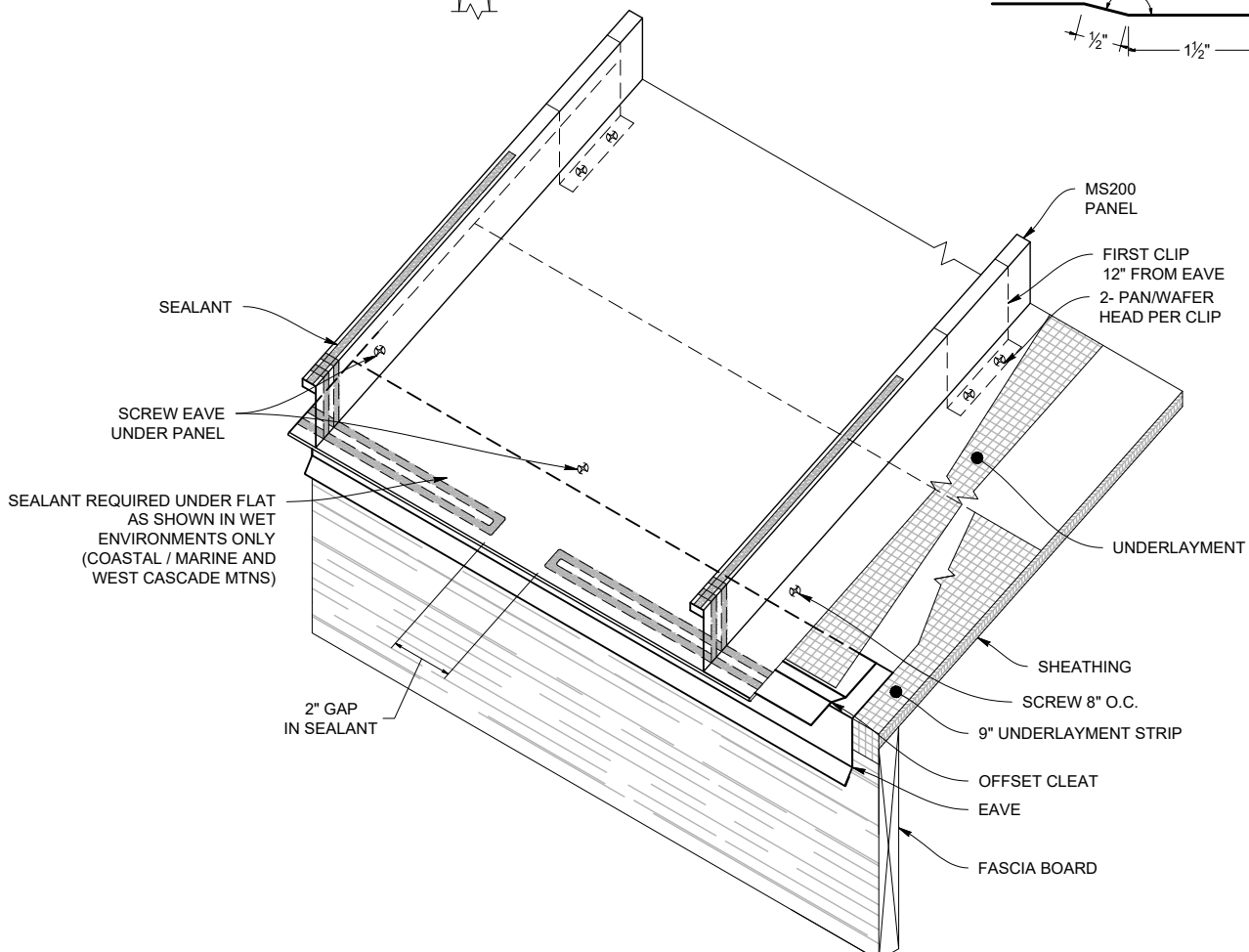
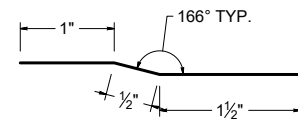

Note: All screws must be fastened into solid substrate.
Flashing must be lapped 4" with 3 rows of gunnable sealant.

HOOK EAVE DETAIL

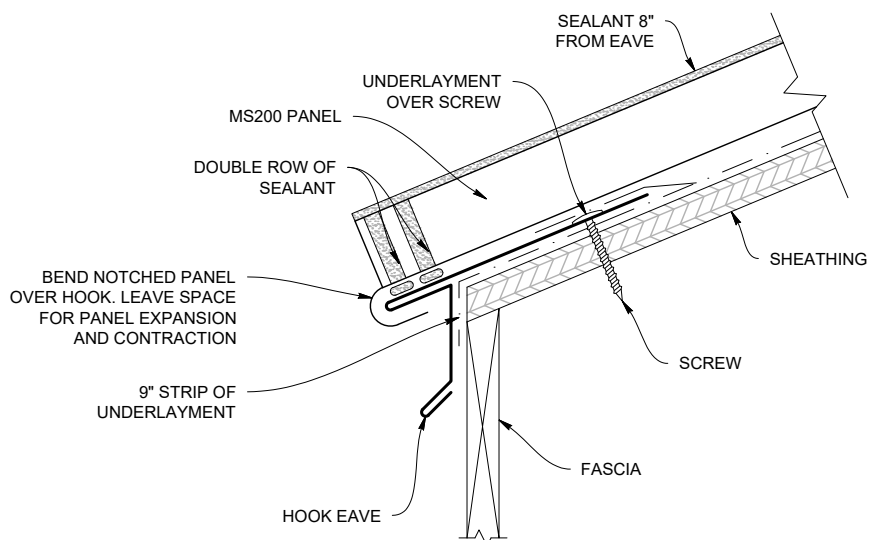

HOOK EAVE (MS200EH)

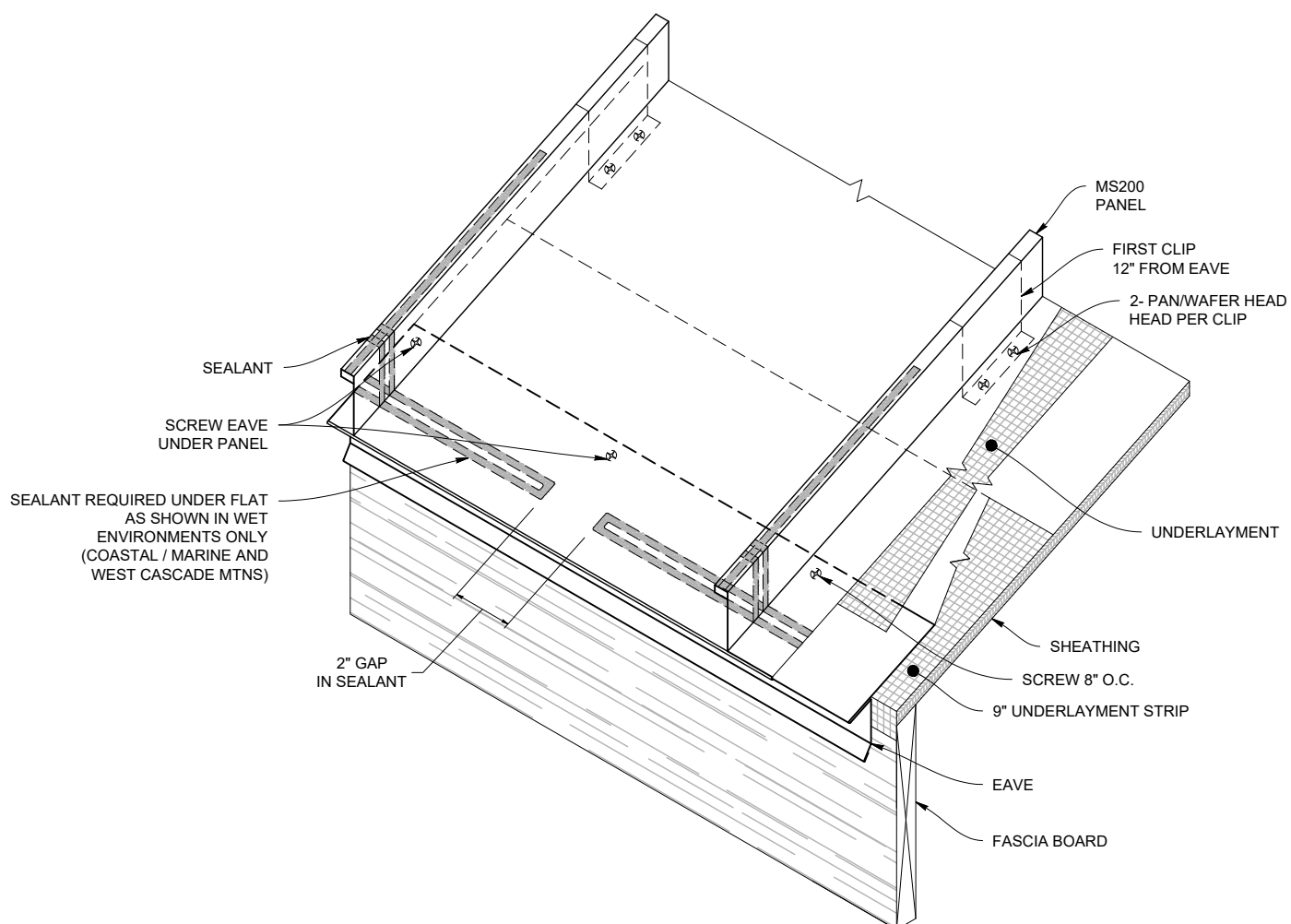
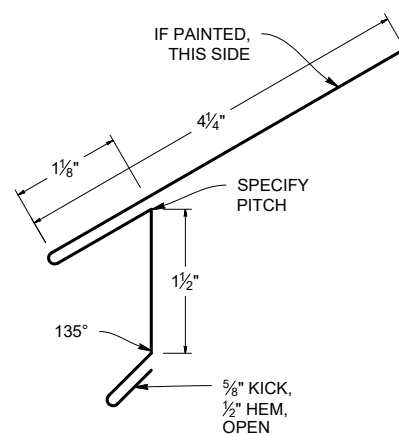

Note: All screws must be fastened into solid substrate.
Flashing must be lapped 4" with 3 rows of gunnable sealant.

Gutter / Hook Eave

HOOK EAVE WITH GUTTER DETAIL

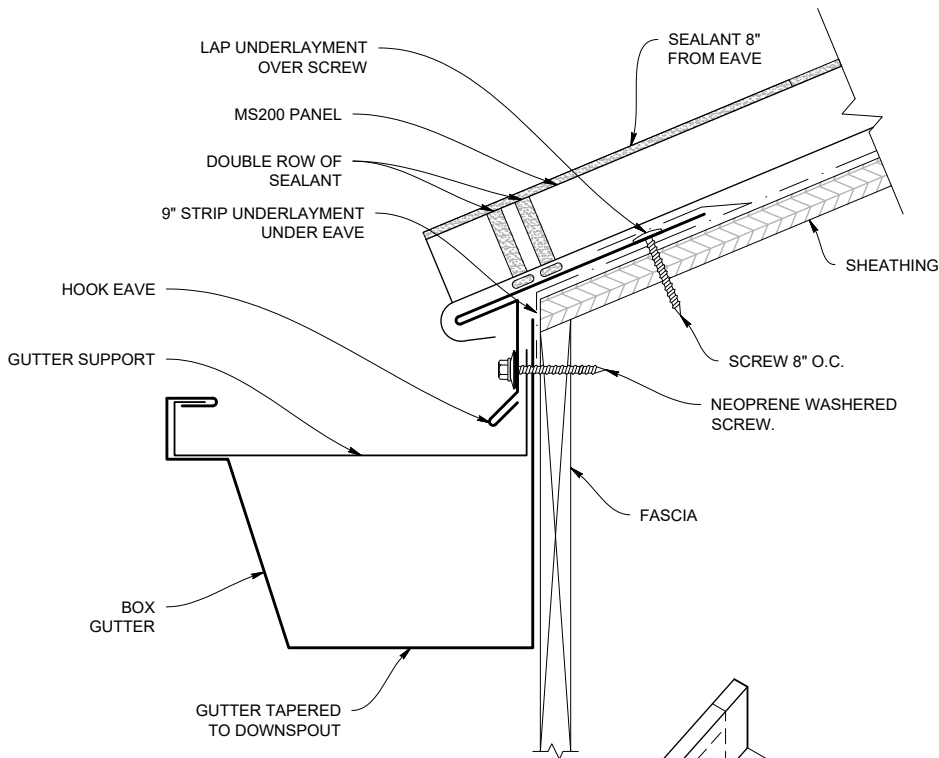

BOX GUTTER (MS200BG)

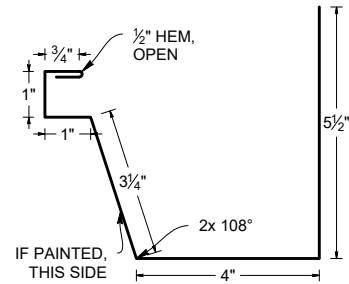

HOOK EAVE (MS200EH)

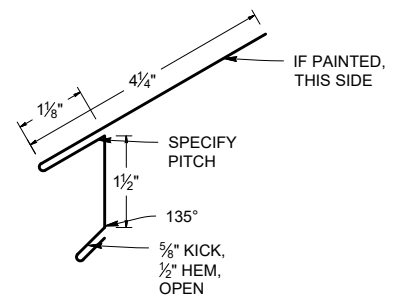

BOX GUTTER HANGER (AGH6)

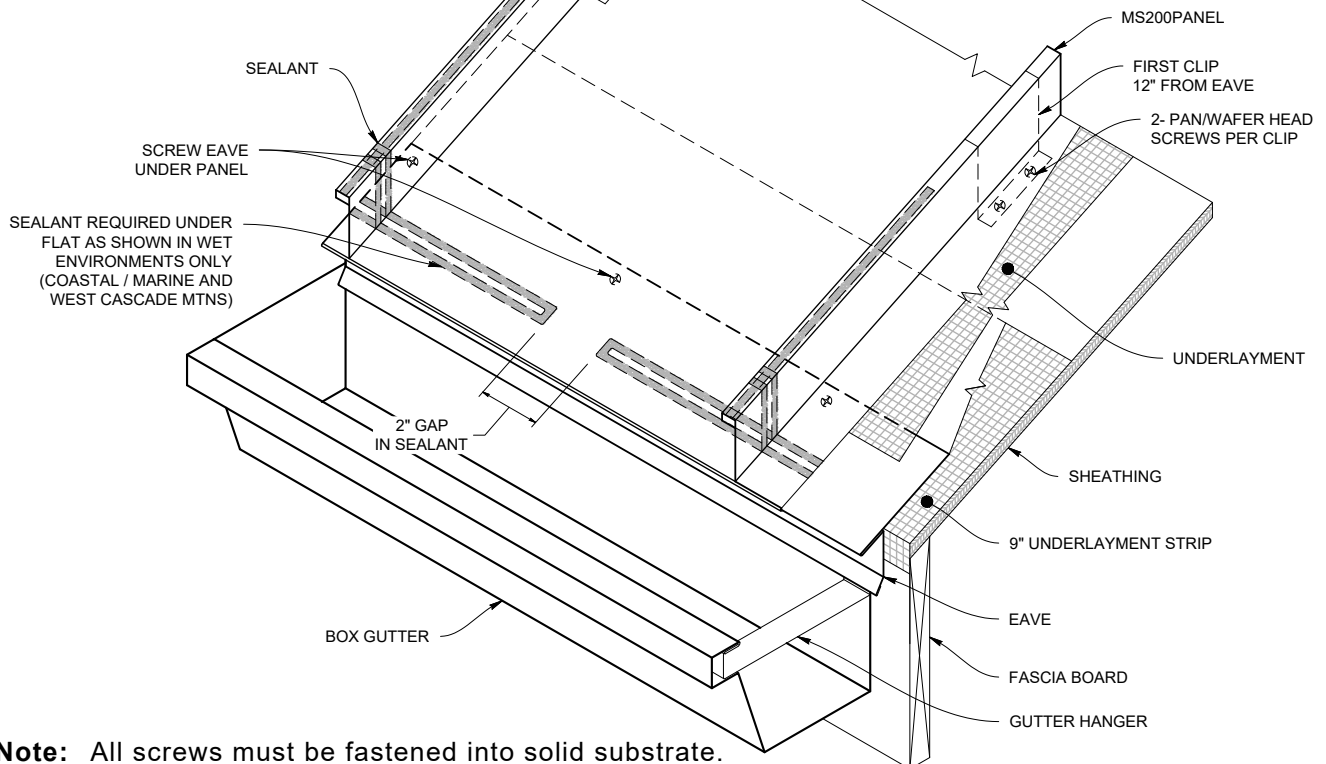
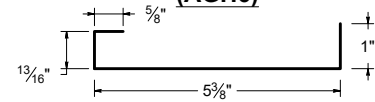

Note: All screws must be fastened into solid substrate.
Flashing must be lapped 4" with 3 rows of gunnable sealant.

STANDARD RIDGE DETAIL

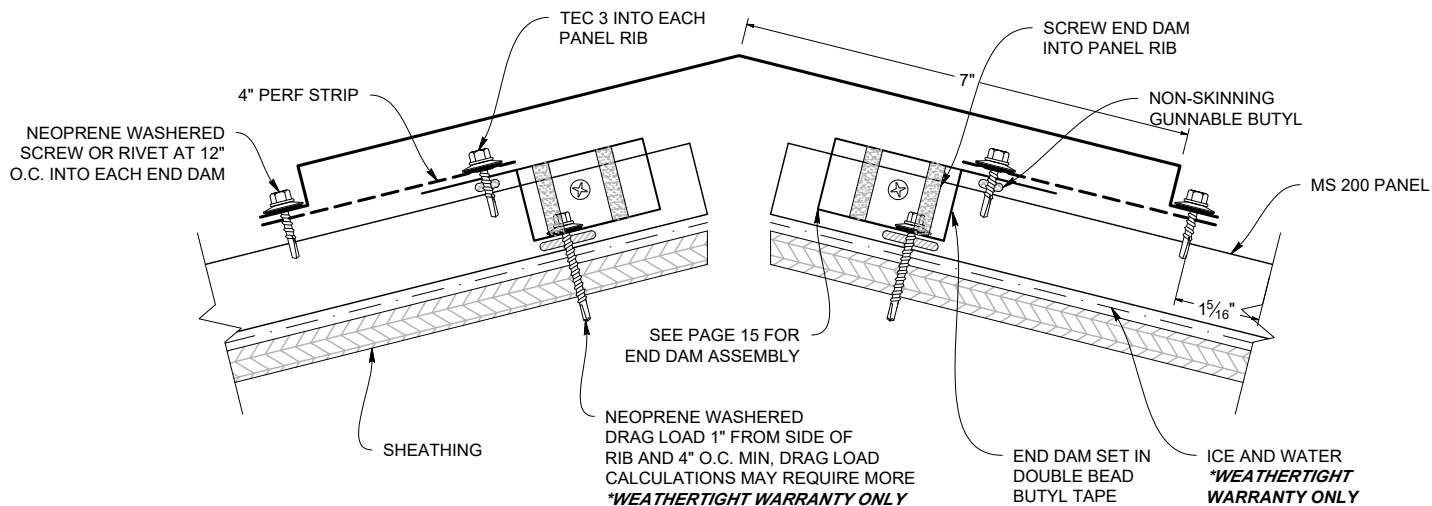

STANDARD RIDGE (MS200RS)

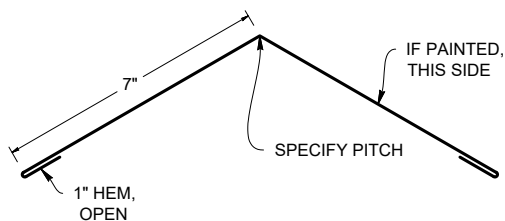

STANDARD RIDGE LAP

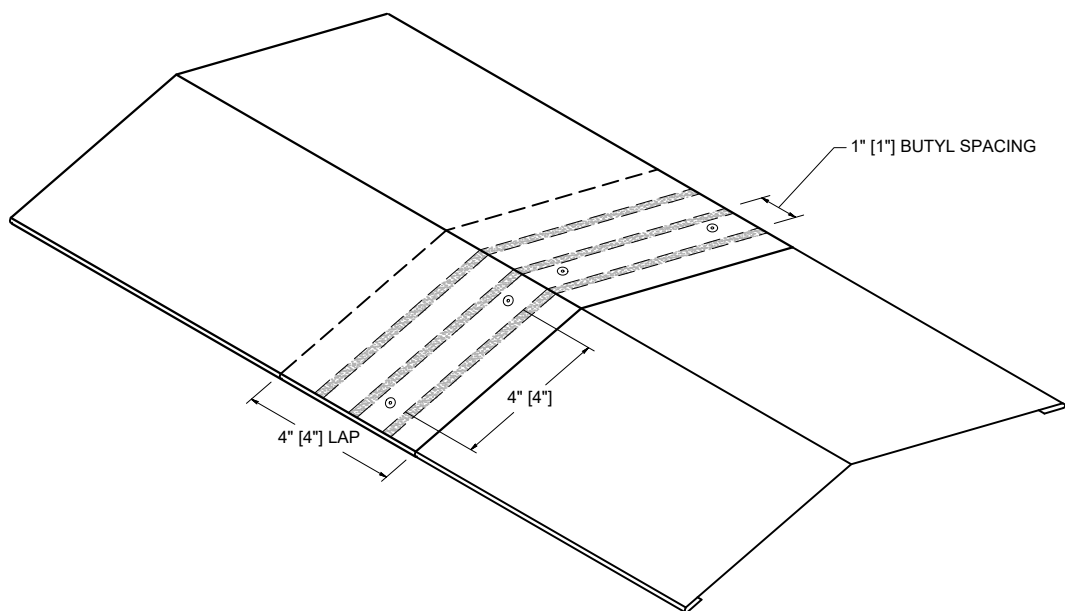

Note: All screws must be fastened into solid substrate.
Flashing must be lapped 4" with 3 rows of gunnable sealant.

Vented Ridge

WT VENTED RIDGE DETAIL

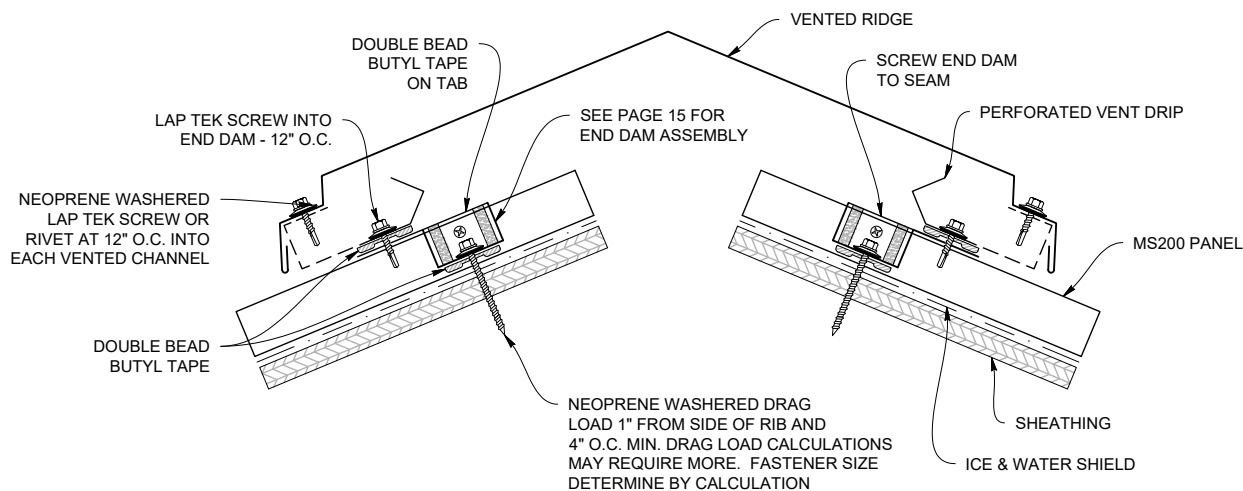

WT RIDGE FULL VENTED (MS200WTRFV)

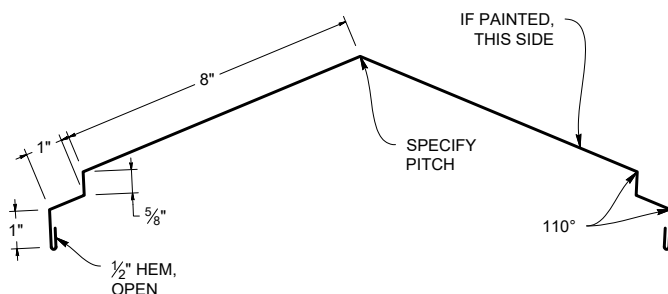

PERFORATED VENT DRIP (MS200PVD)

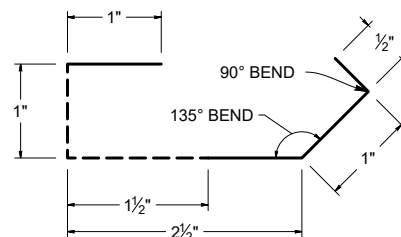

VENTED RIDGE LAP

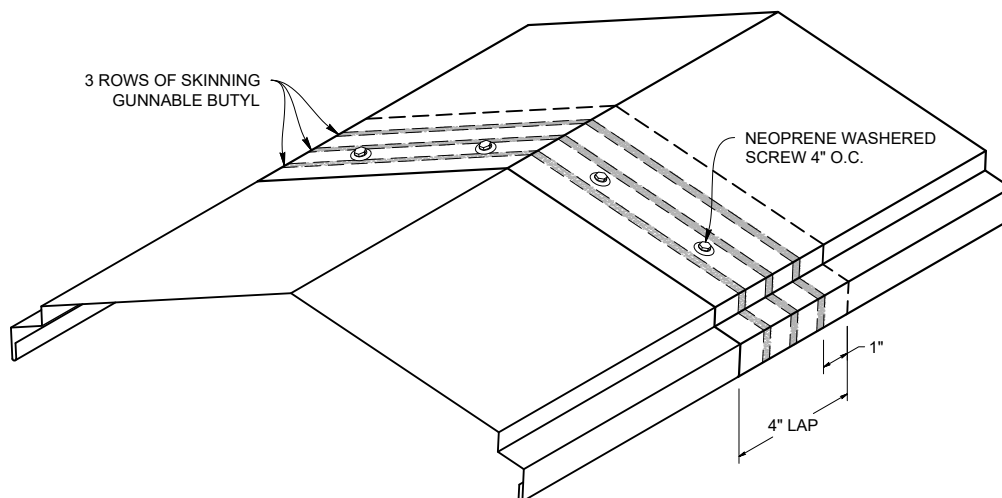

Note: All screws must be fastened into solid substrate.
Flashing must be lapped 4" with 3 rows of gunnable sealant.

End Dam Attachment

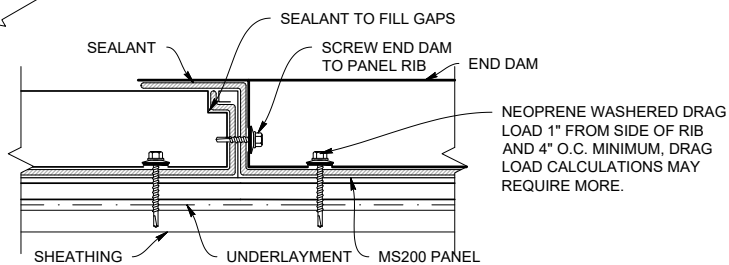
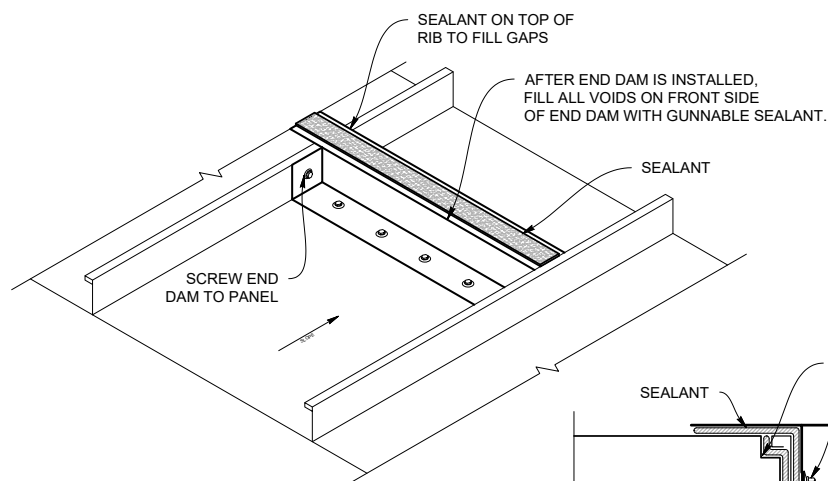
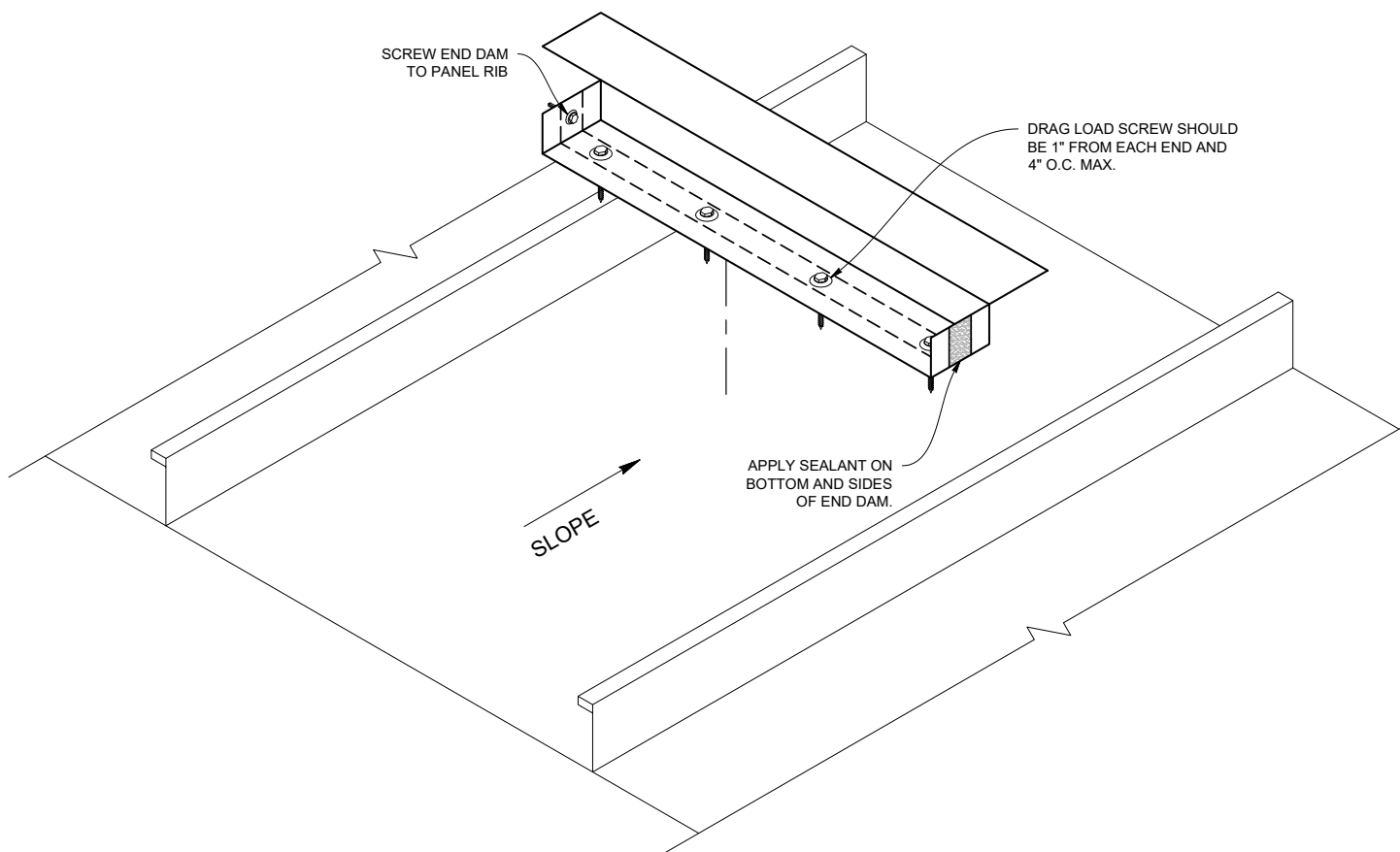

Note: All screws must be fastened into solid substrate.
Flashing must be lapped 4" with 3 rows of gunnable sealant.

Valley Flashing

Slope 3:12 or Greater



VALLEY 24" FLASHING (MS200VF)

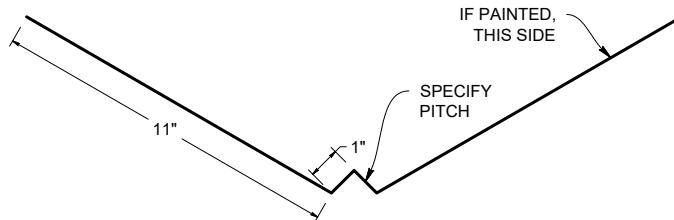

OFFSET CLEAT (MS200OC)

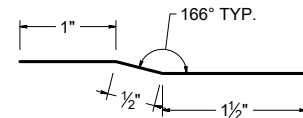

VALLEY 24" DETAIL (3:12 Or Greater Pitch)

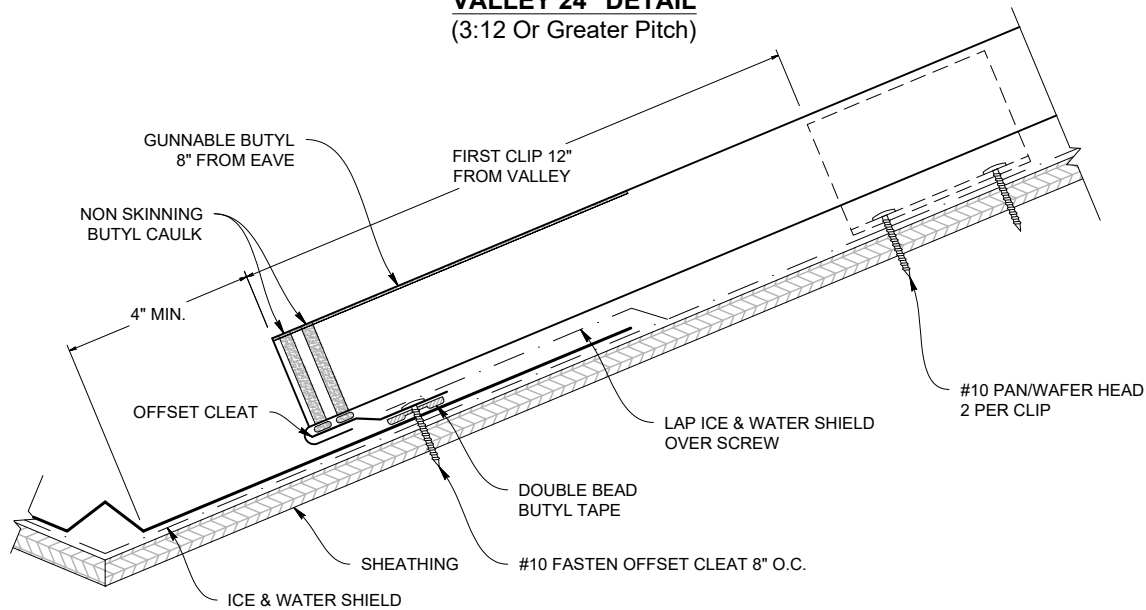

VALLEY LAP (3:12 Or Greater Pitch)

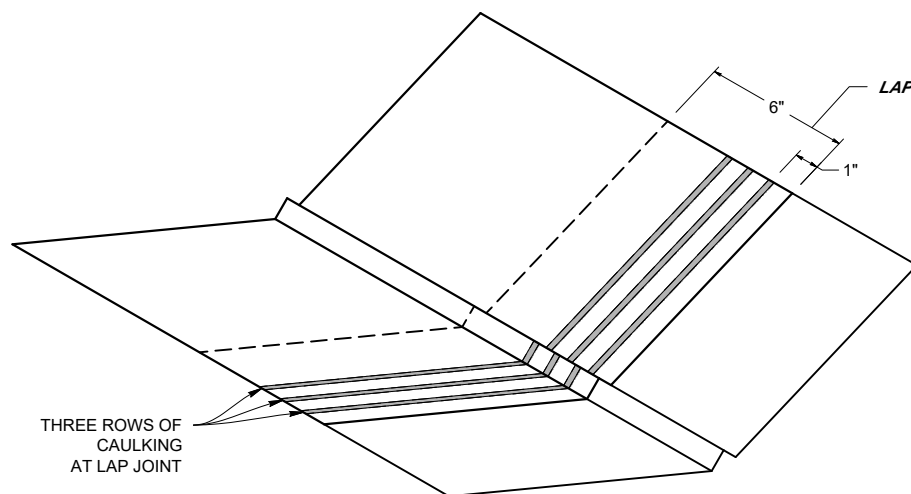

Note: All screws must be fastened into solid substrate.
Flashing must be lapped 4" with 3 rows of gunnable sealant.

LOW SLOPE VALLEY DETAIL

(Less Than 3 :12 Pitch)

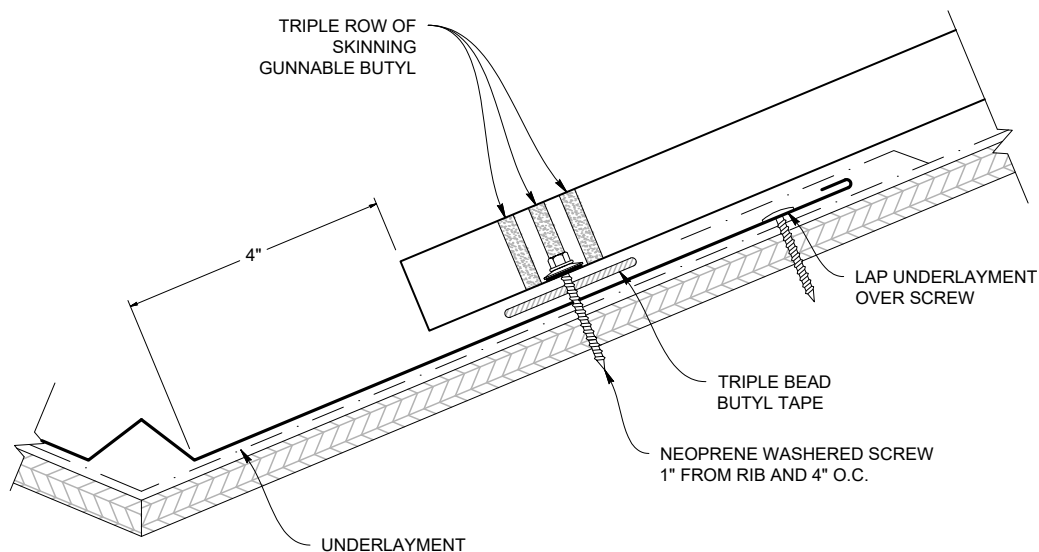

VALLEY FLASHING

(MS200VF)

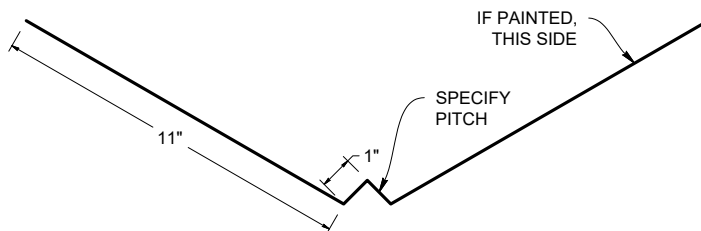

LOW SLOPE VALLEY LAP

(Less Than 3 :12 Pitch)

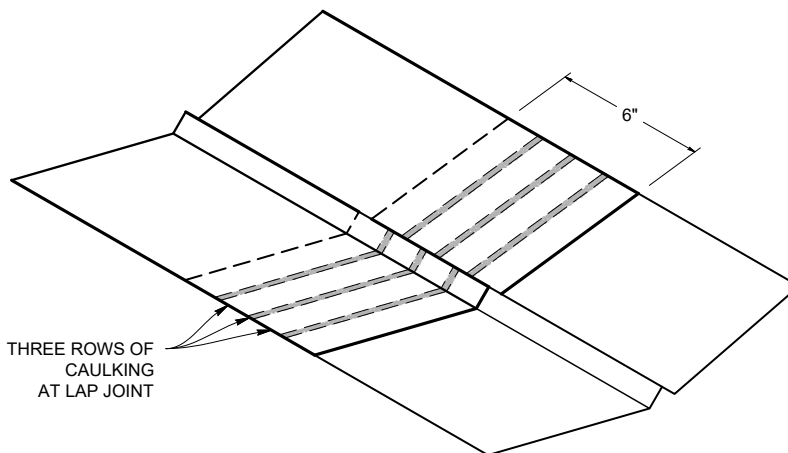

Note: All screws must be fastened into solid substrate.
Flashing must be lapped 4" with 3 rows of gunnable sealant.

Standard Gable

GABLE DETAIL

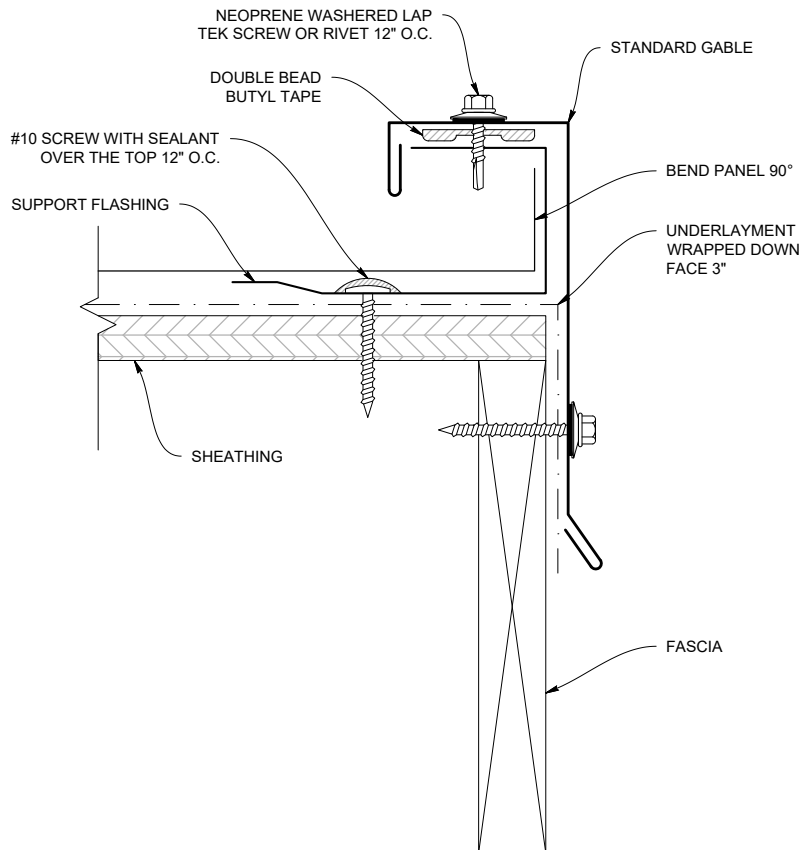

GABLE (MS200GS)

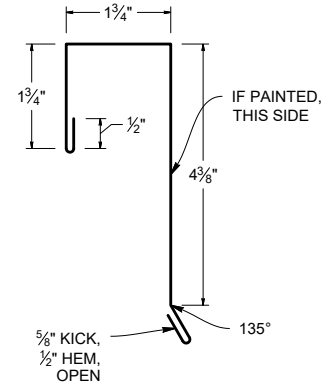

SUPPORT FLASHING (MS200SF)

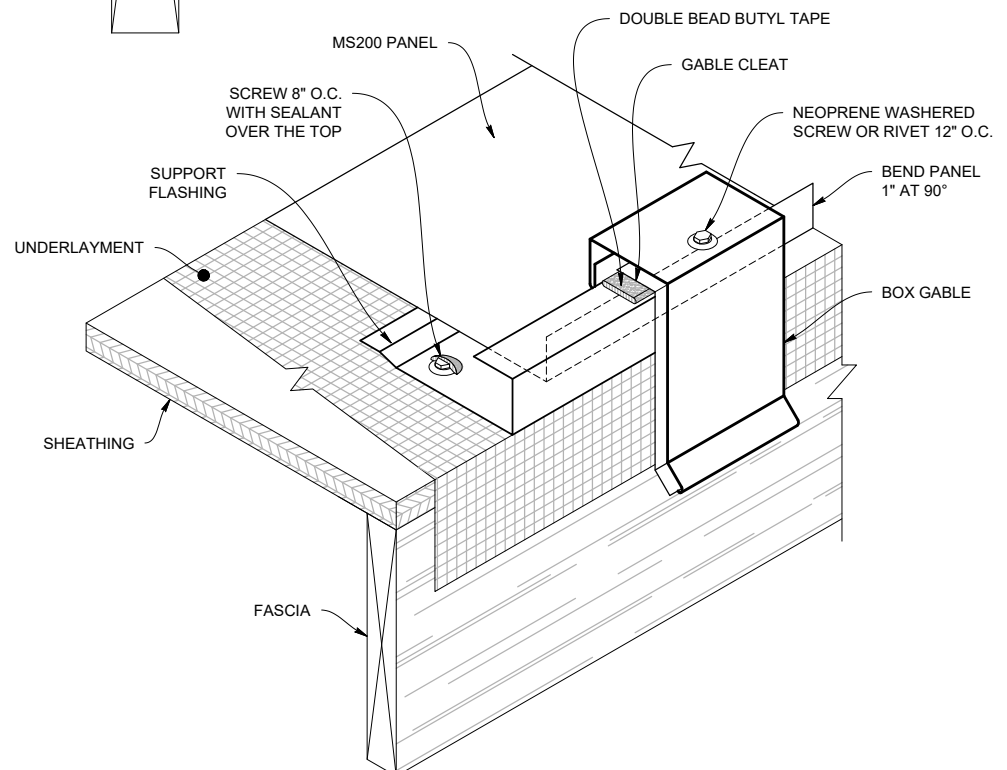
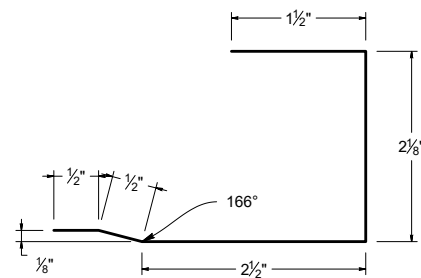

ALTERNATE GABLE DETAIL

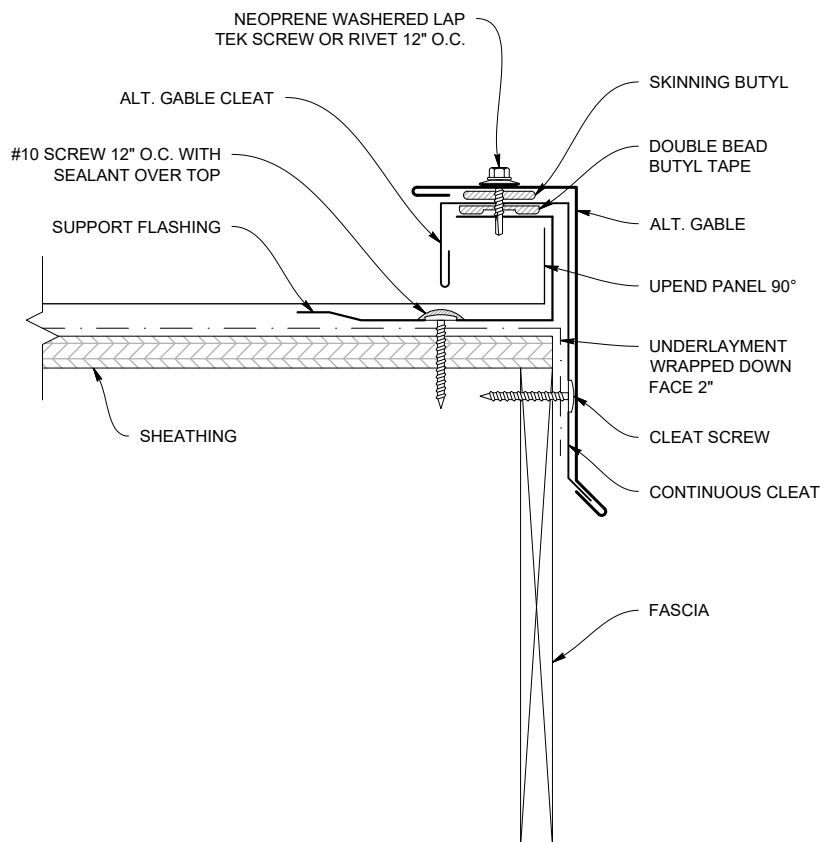

ALTERNATE GABLE (MS200AG)

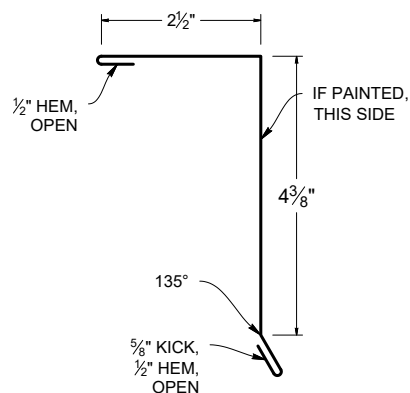

SUPPORT FLASHING (MS200SF)

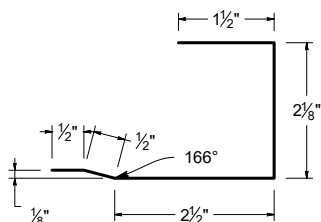

ALTERNATE GABLE CLEAT (MS200AGT)

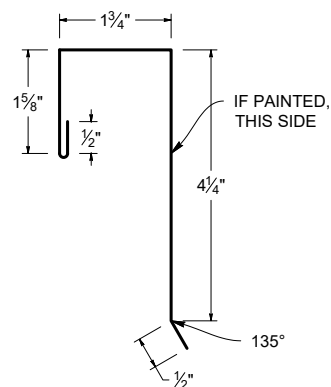

Note: All screws must be fastened into solid substrate.
Flashing must be lapped 4" with 3 rows of gunnable sealant.

Sidewall

SIDEWALL DETAIL

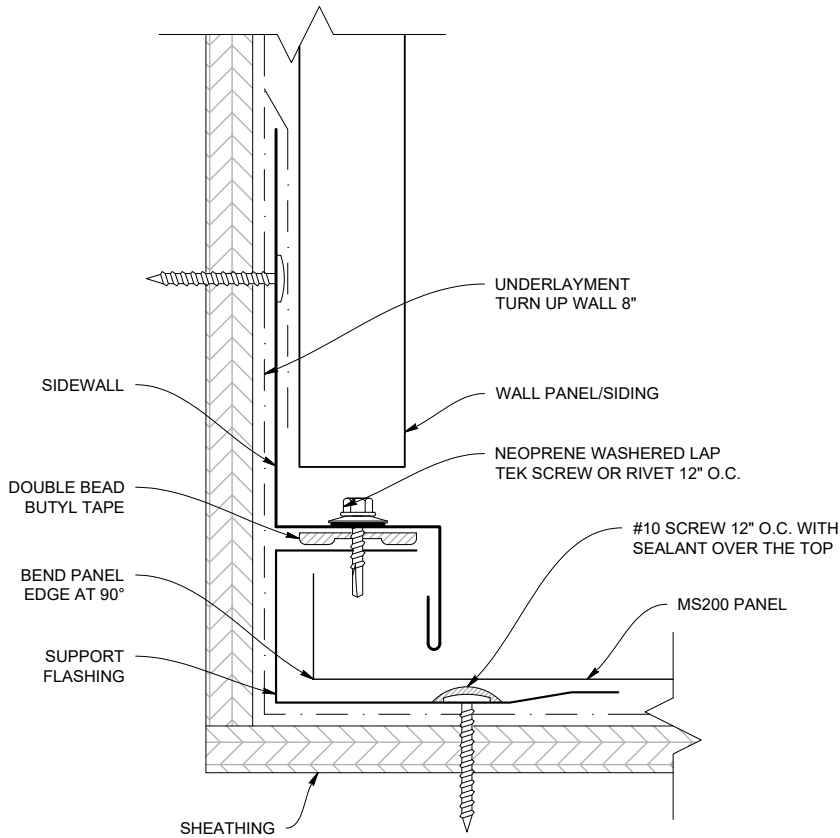

SIDEWALL (MS200SW)

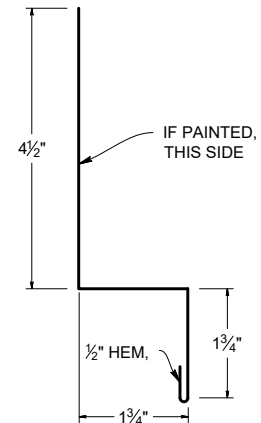

SUPPORT FLASHING (MS200SF)

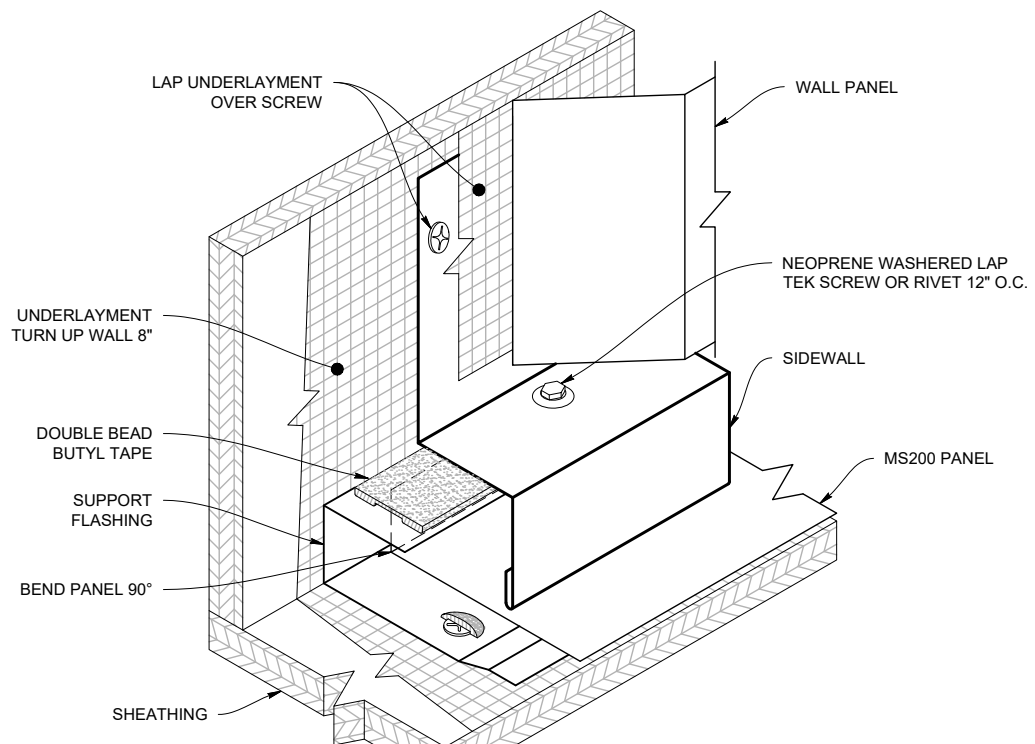
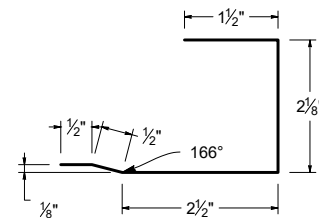

Note: All screws must be fastened into solid substrate.
Flashing must be lapped 4" with 3 rows of gunnable sealant.

PEAK FLASHING DETAIL

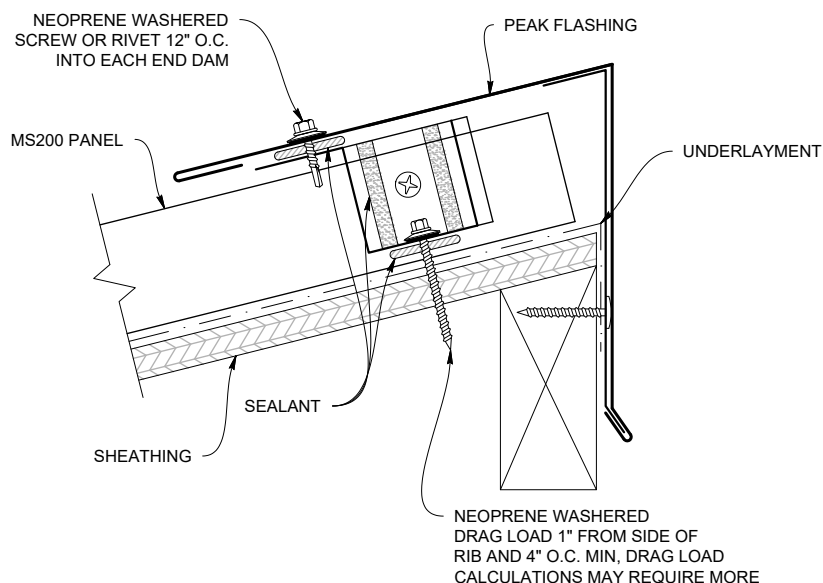

PEAK FLASHING (MS200REC)

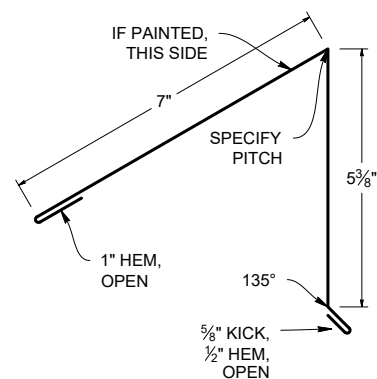

PEAK CLEAT (MS200RECC)

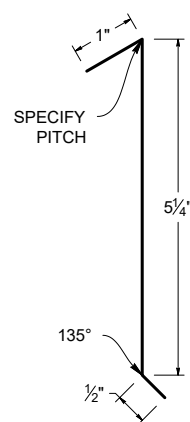

PEAK FLASHING LAP

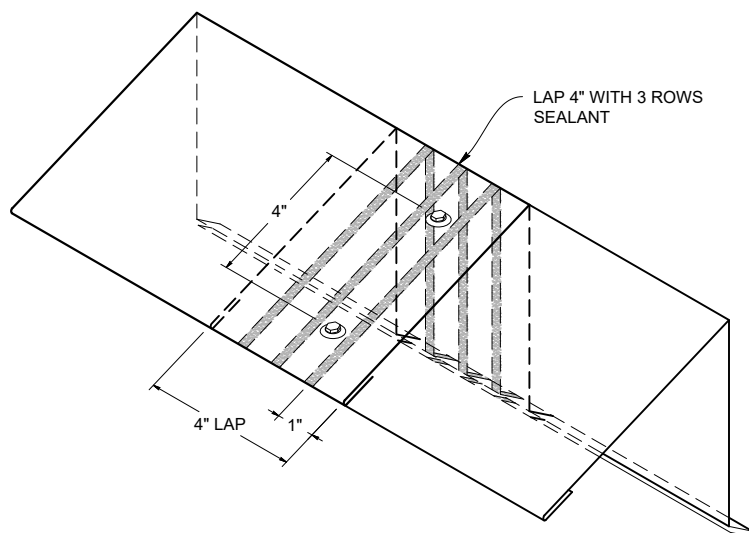

Note: All screws must be fastened into solid substrate.
Flashing must be lapped 4" with 3 rows of gunnable sealant.

Vented Peak Flashing

(Ridge End Cap)



VENTED PEAK FLASHING DETAIL (Vented Ridge End Cap)

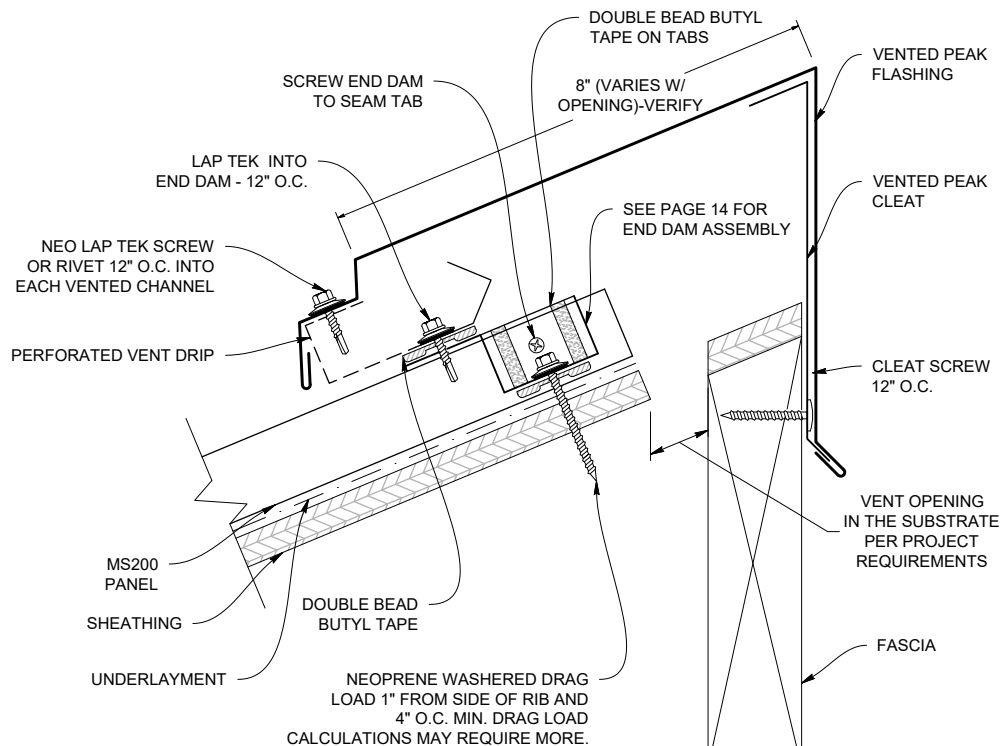

VENTED PEAK FLASHING LAP

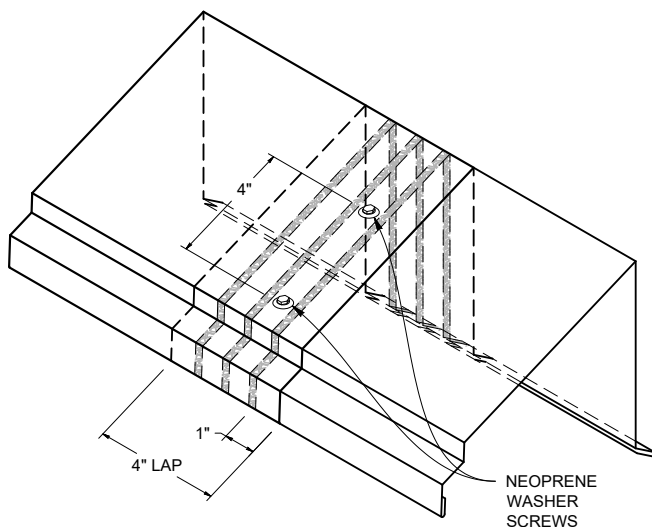

VENTED PEAK CLEAT (MS200VRECC)

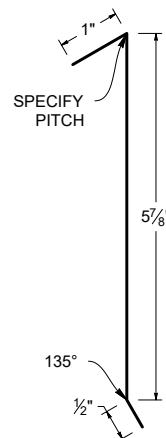

WT VENTED PEAK FLASHING (MS200WTRCV)

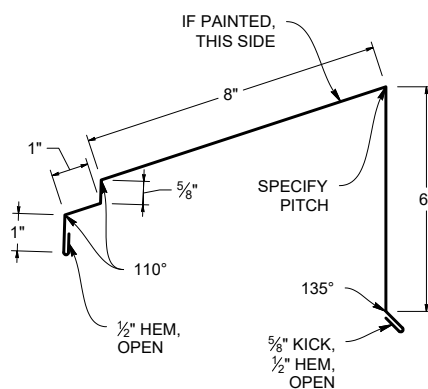

PERFORATED VENT DRIP (MS200PVD)

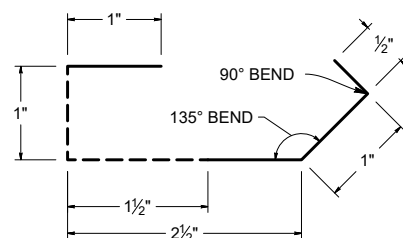

Note: All screws must be fastened into solid substrate.
Flashing must be lapped 4" with 3 rows of gunnable sealant.

PITCH CHANGE DETAIL

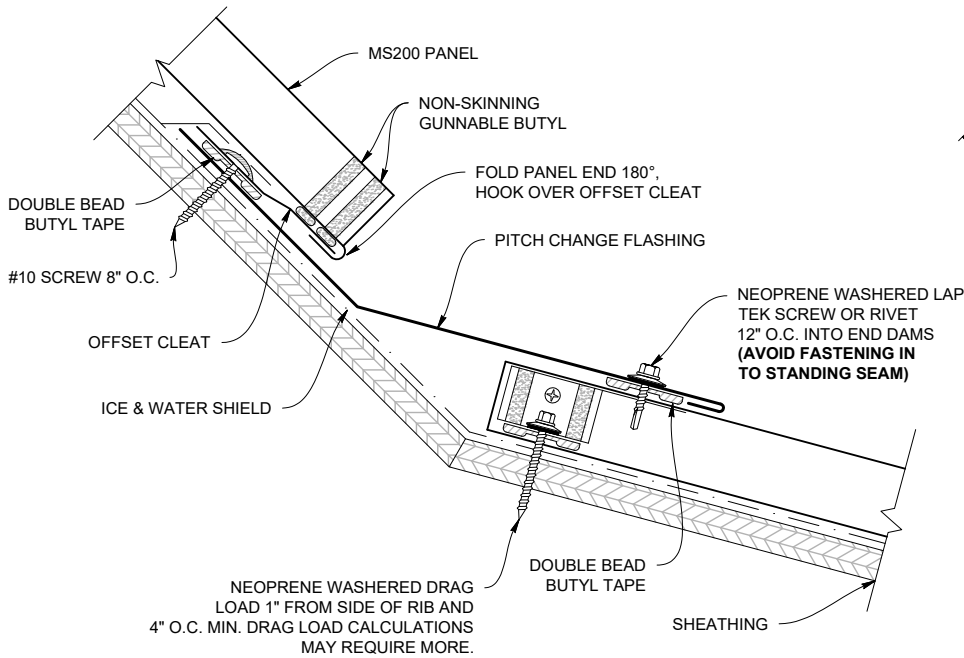

INSIDE PITCH CHANGE FLASHING

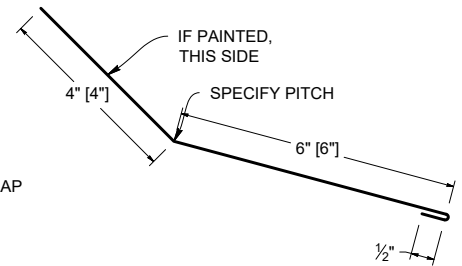

OFFSET CLEAT (MS200OC)

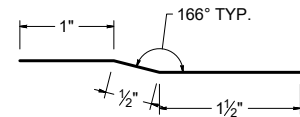

PITCH CHANGE LAP

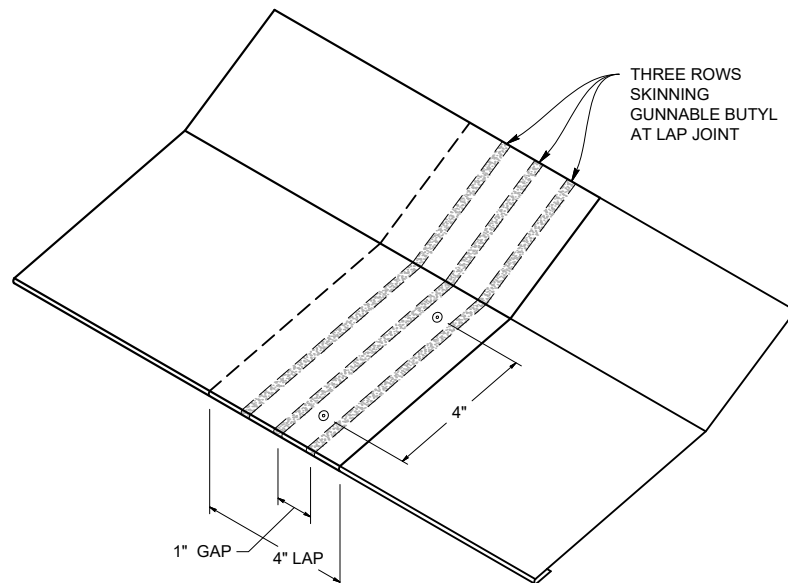

Note: All screws must be fastened into solid substrate.
Flashing must be lapped 4" with 3 rows of gunnable sealant.

ENDWALL DETAIL

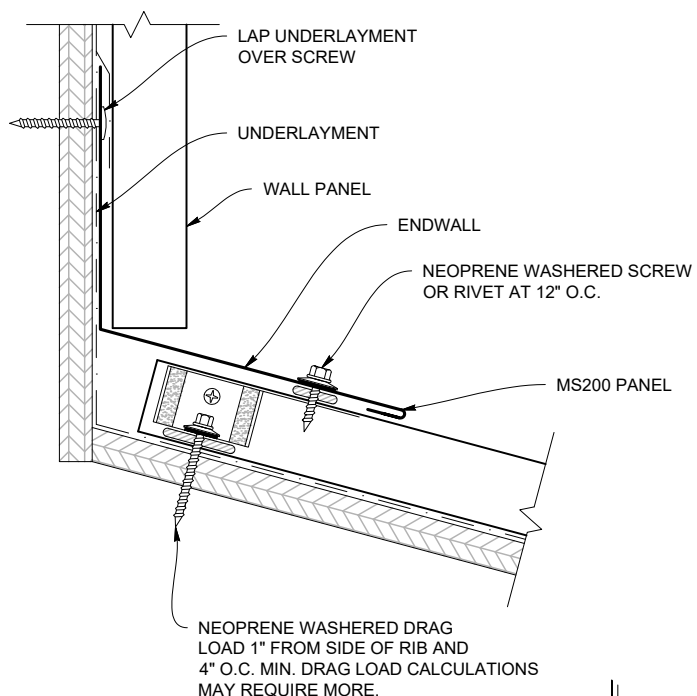

ENDWALL FLASHING (MS200EW)

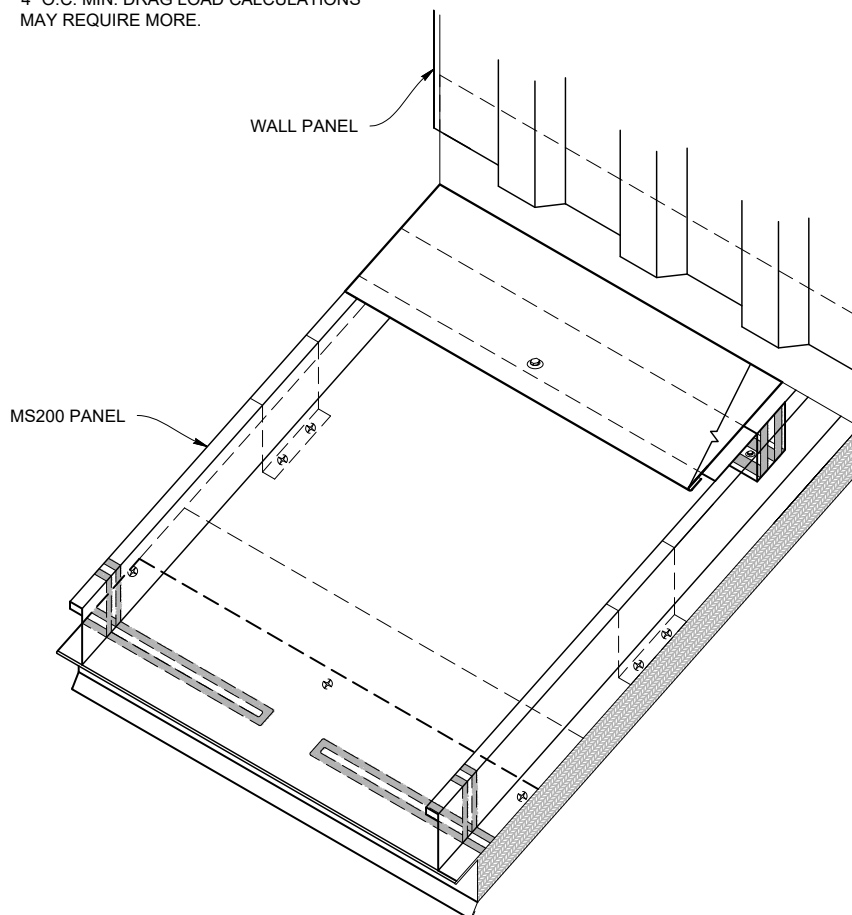
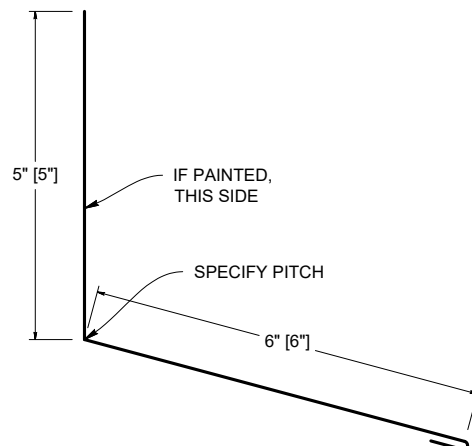

Note: All screws must be fastened into solid substrate.
Flashing must be lapped 4" with 3 rows of gunnable sealant.

WT VENTED ENDWALL DETAIL

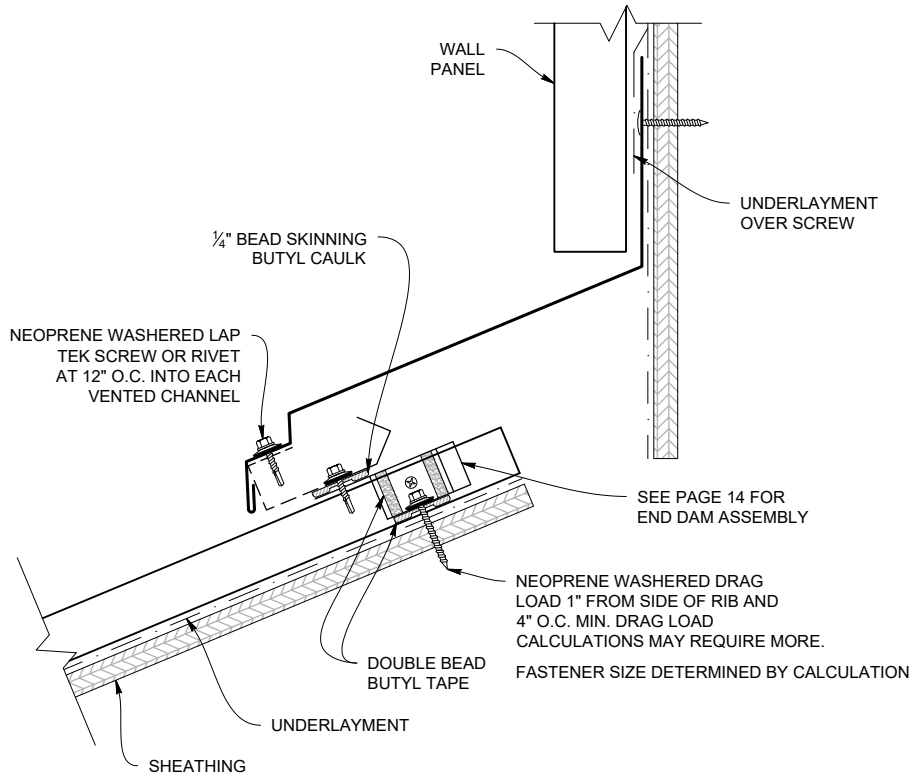

ENDWALL LAP

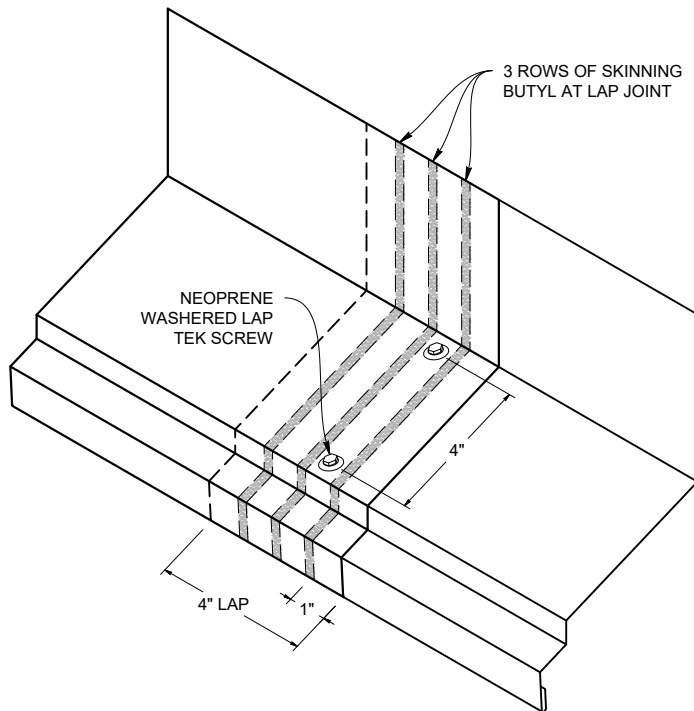

WT VENTED ENDWALL FLASHING (MS200WTEWV)

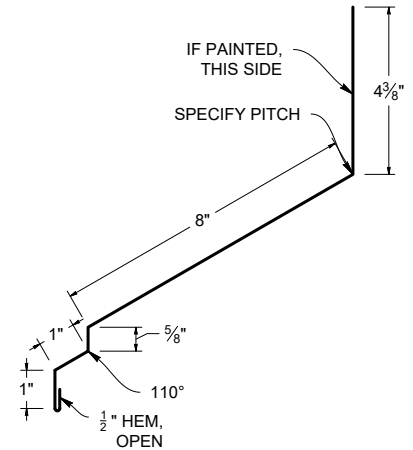

PERFORATED VENT DRIP (MS200PVD)

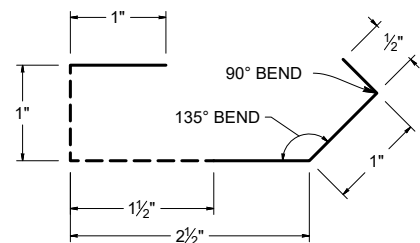

Note: All screws must be fastened into solid substrate.
Flashing must be lapped 4" with 3 rows of gunnable sealant.

Endwall w/ Saw Cut Reglet

SAW CUT ENDWALL DETAIL

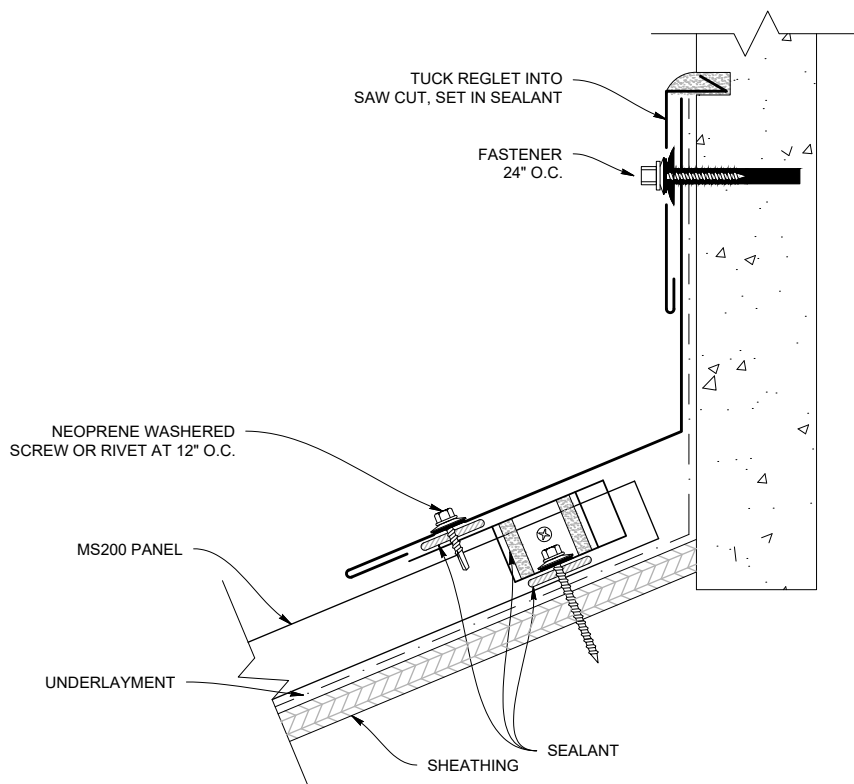

REGLET (MS200RF)

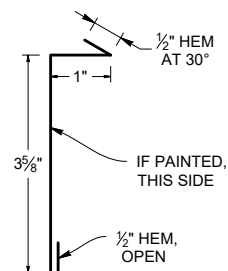

ENDWALL (MS200EW)

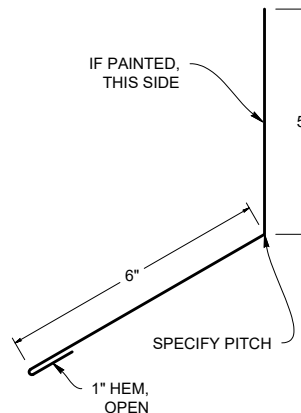

END DAM DETAIL

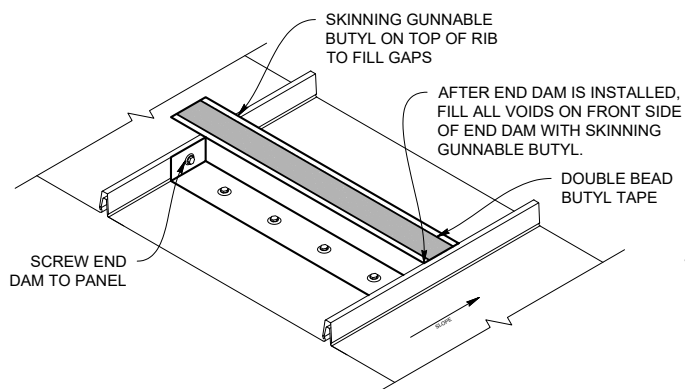

ENDWALL LAP

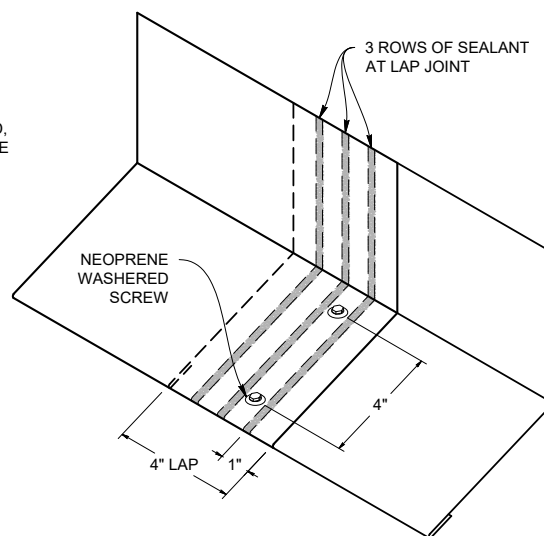

Note: All screws must be fastened into solid substrate.
Flashing must be lapped 4" with 3 rows of gunnable sealant.

STEP 1

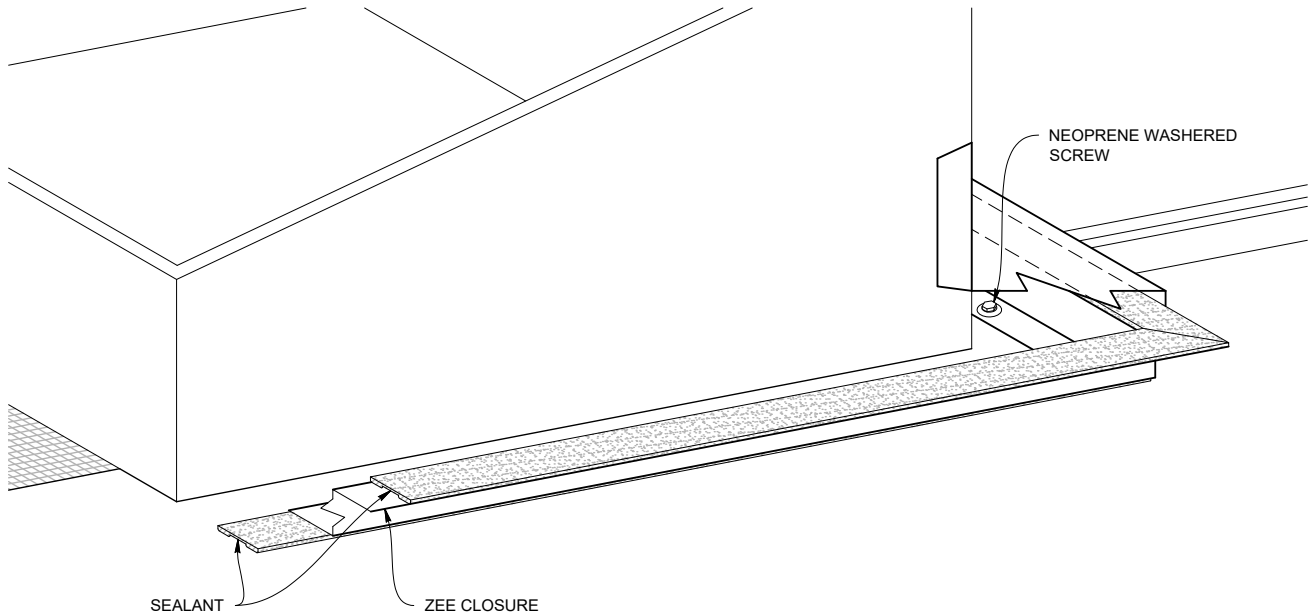

STEP 2

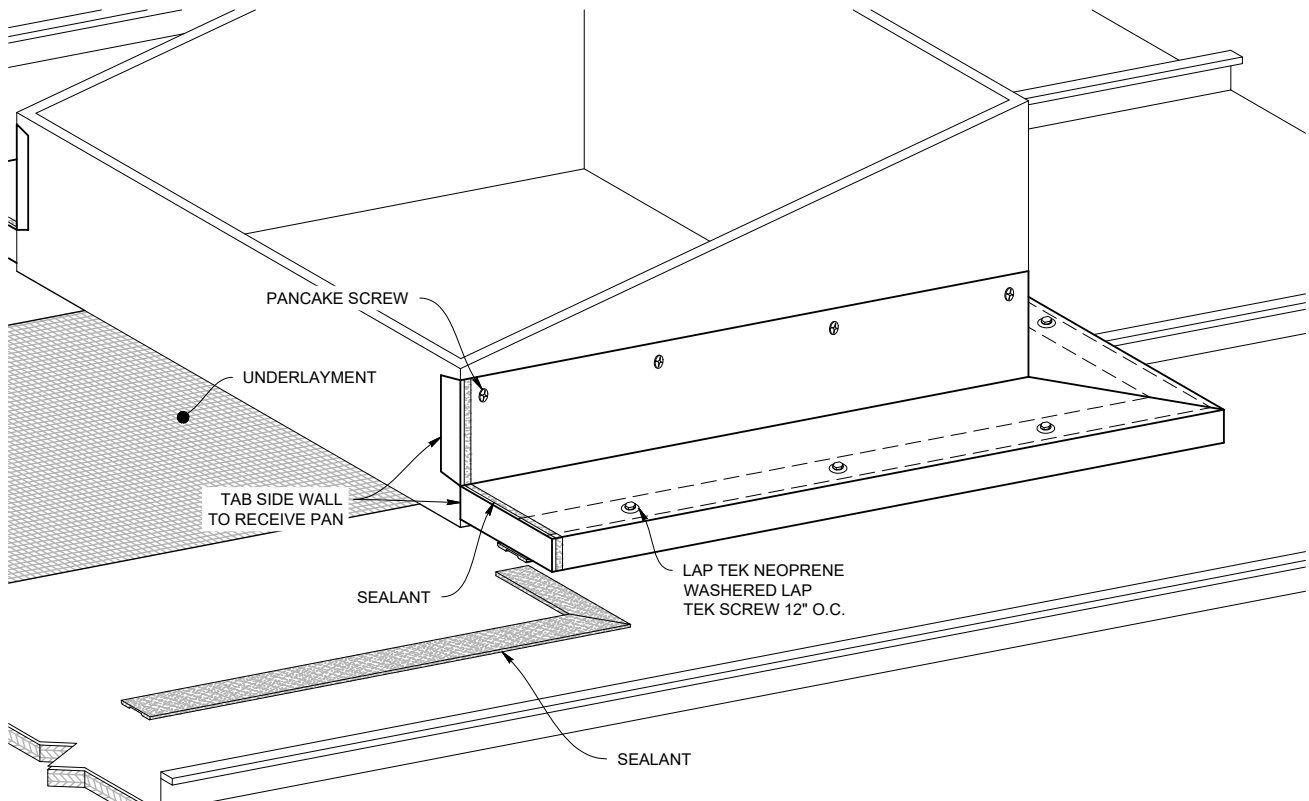

Note: All screws must be fastened into solid substrate.
Flashing must be lapped 4" with 3 rows of gunnable sealant.

Curb Back Pan / Cricket

STEP 3

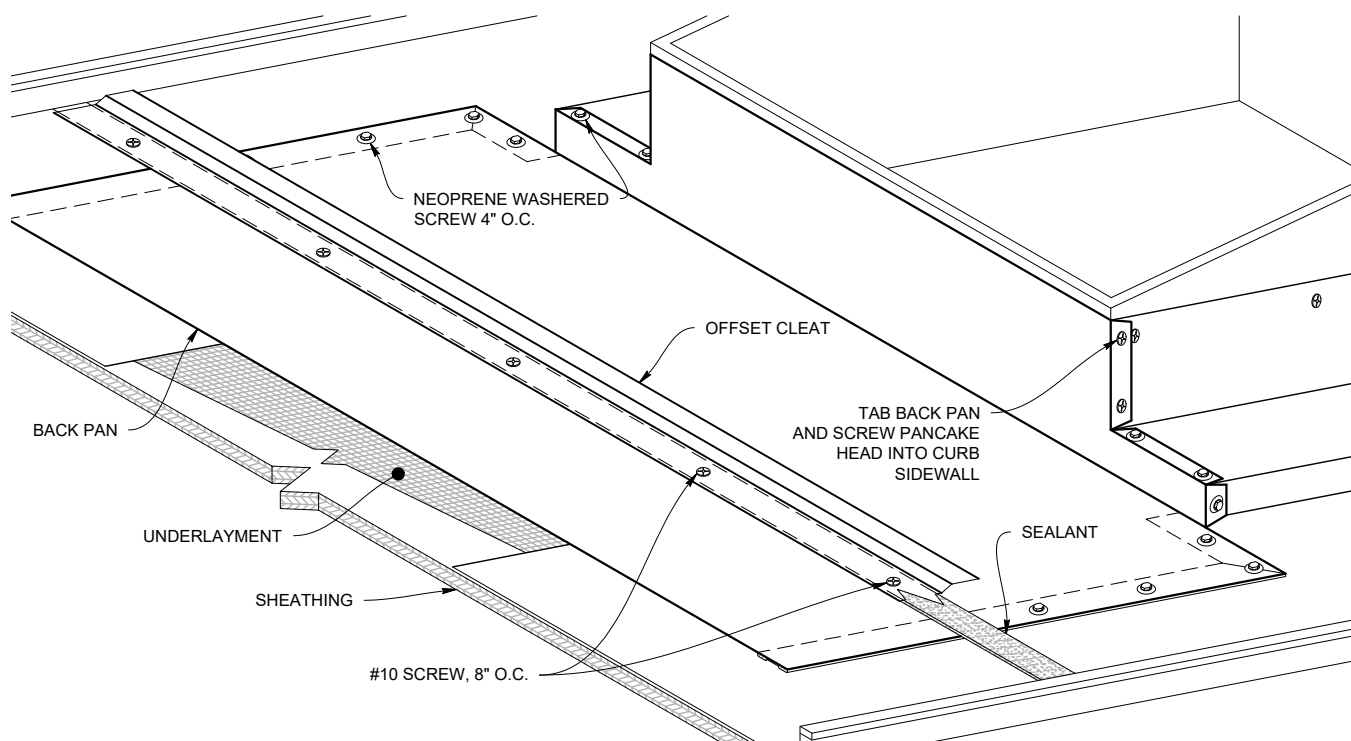

STEP 4

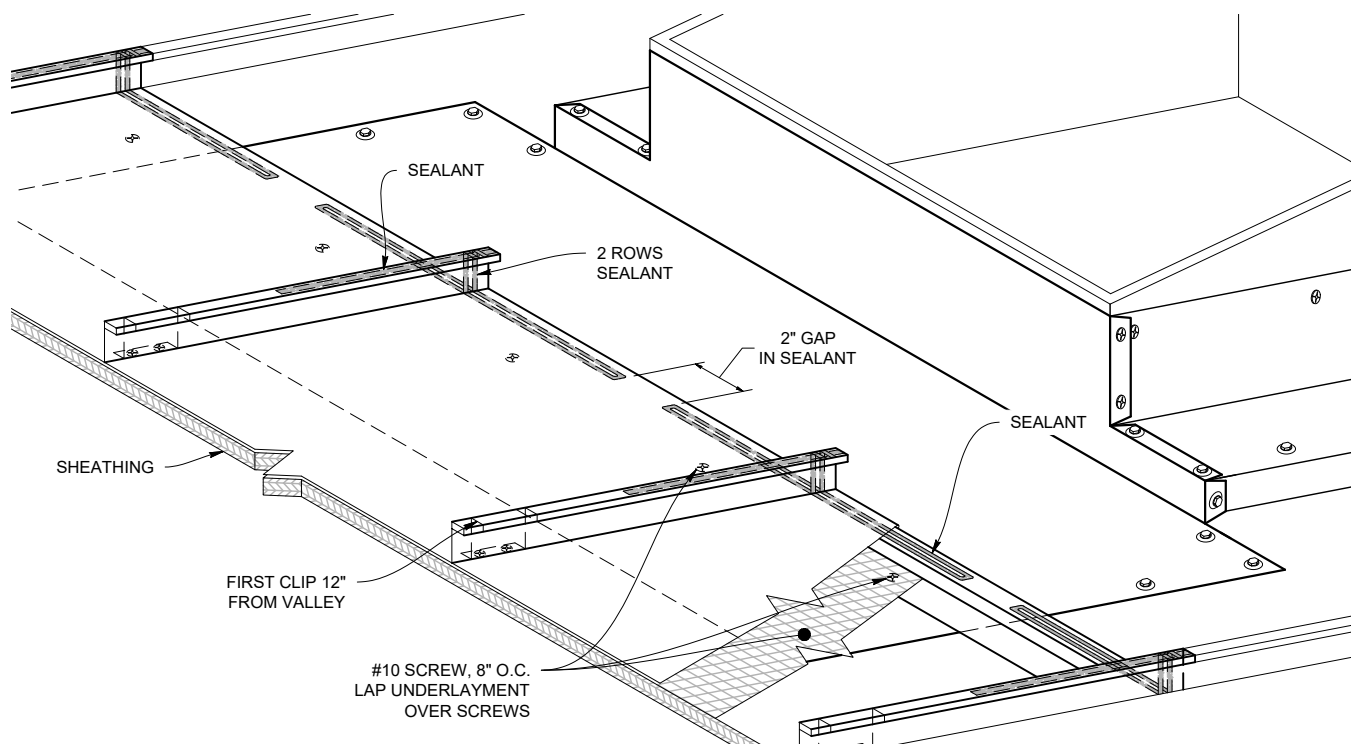

Note: All screws must be fastened into solid substrate.
Flashing must be lapped 4" with 3 rows of gunnable sealant.

SEALANT

SEALANT

LEAVE GAP IN SEALANT

This technical diagram illustrates the correct installation of a roof-to-wall connection. It shows a cross-section of a roof structure with a metal curb and a wall. The roof deck is shown with a gap between the curb and the wall. The sealant is applied in a continuous bead along the curb and the wall. A specific instruction points to the corner joint, stating 'LEAVE GAP IN SEALANT'. The diagram also shows the curb being fastened to the roof deck with screws. The wall is shown with a vertical seam and a horizontal seam, both secured with screws. The sealant is shown filling the gaps between the curb and the wall, and between the wall and the roof deck.

29

CURB SIDEWALL DETAIL

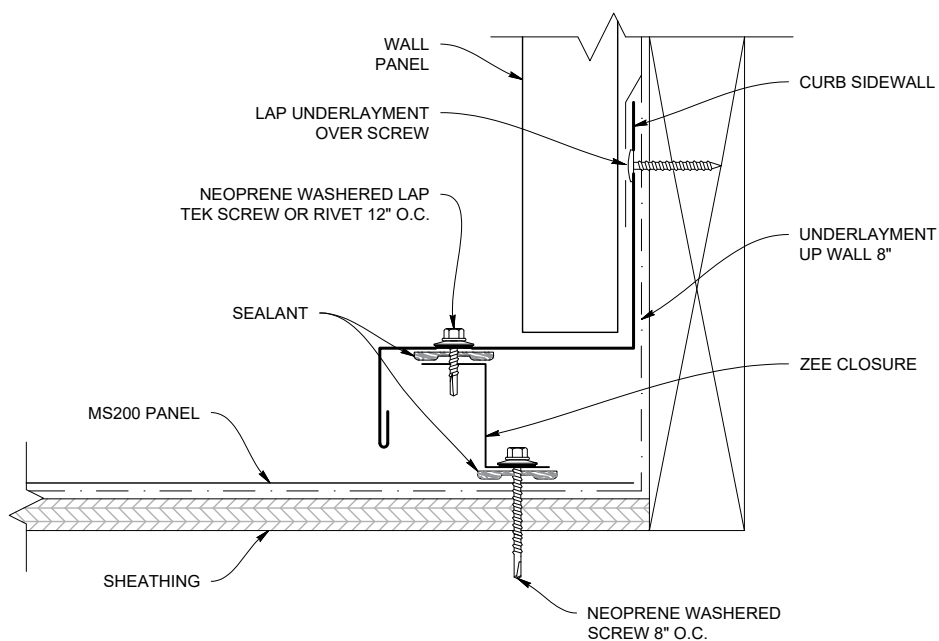

ZEE CLOSURE (MS200ZC)

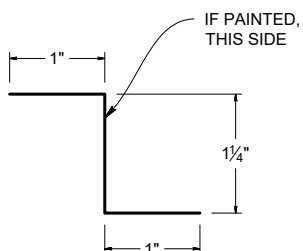

CURB SIDEWALL (MS200CSW)

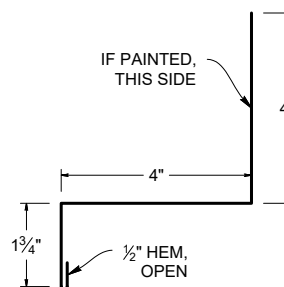

Note: All screws must be fastened into solid substrate.
Flashing must be lapped 4" with 3 rows of gunnable sealant.

CURB ENDWALL DETAIL

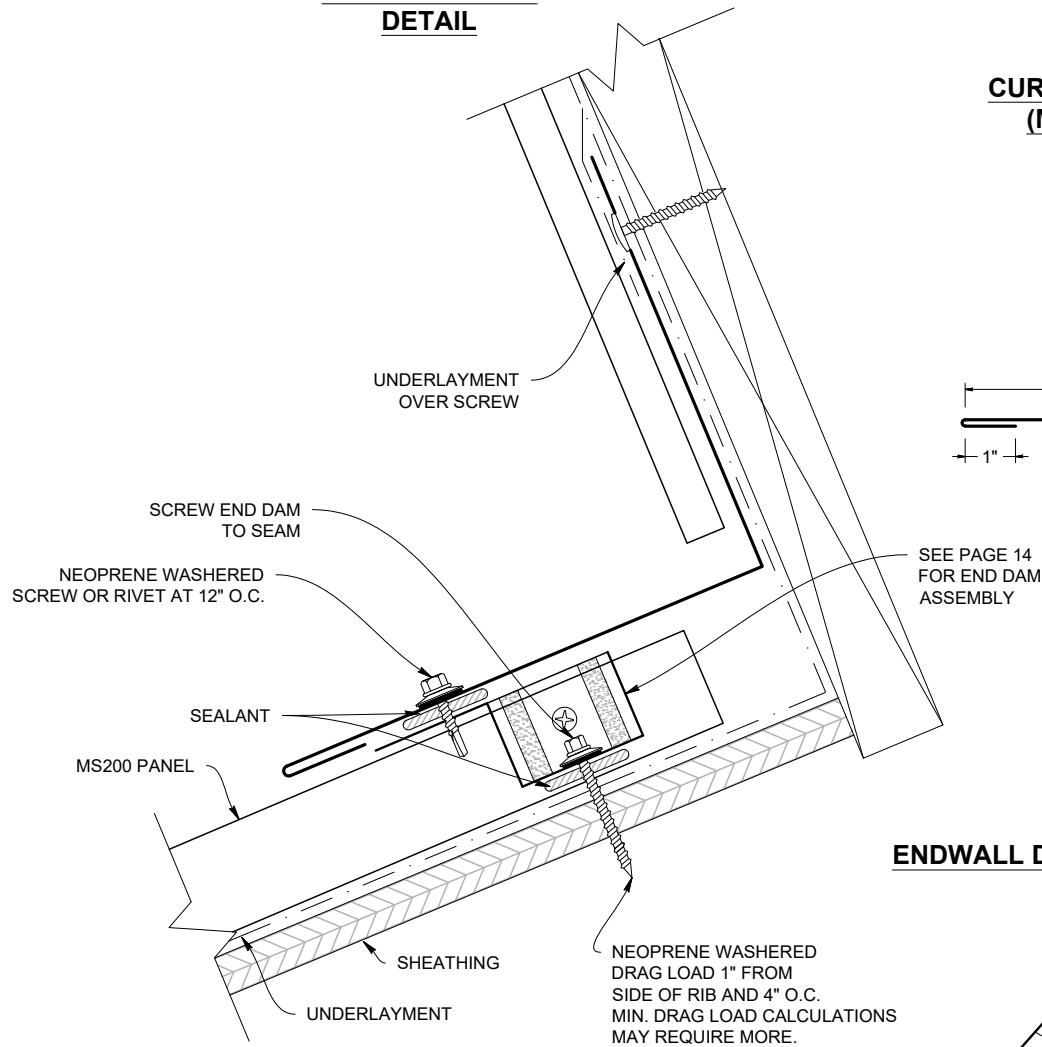

CURB ENDWALL (MS200CH)

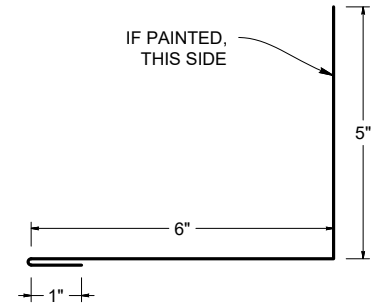

END DAM DETAIL

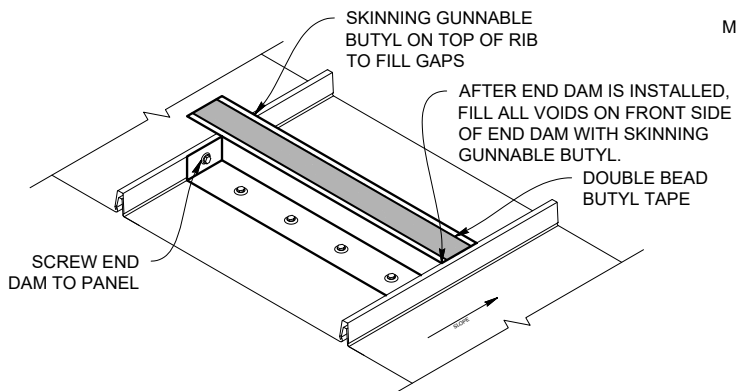

ENDWALL DETAIL

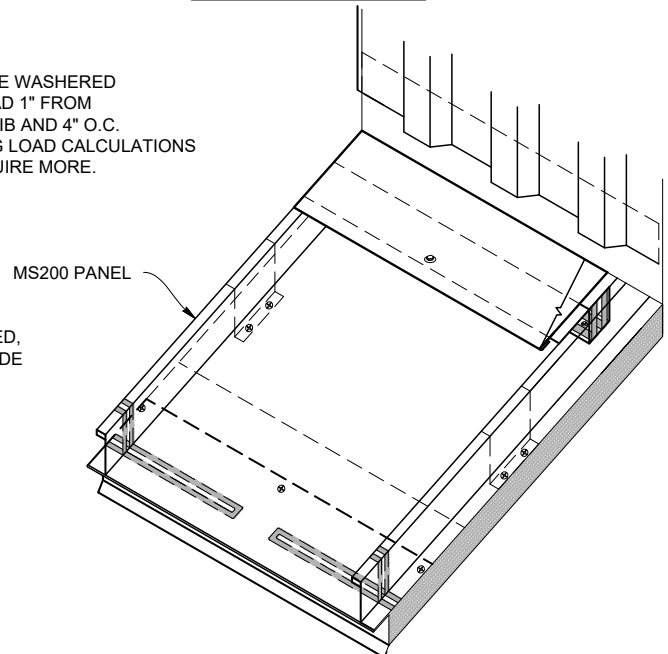

Note: All screws must be fastened into solid substrate.
Flashing must be lapped 4" with 3 rows of gunnable sealant.

Curb / Pan Cricket

(Slope 3:12 or Greater)

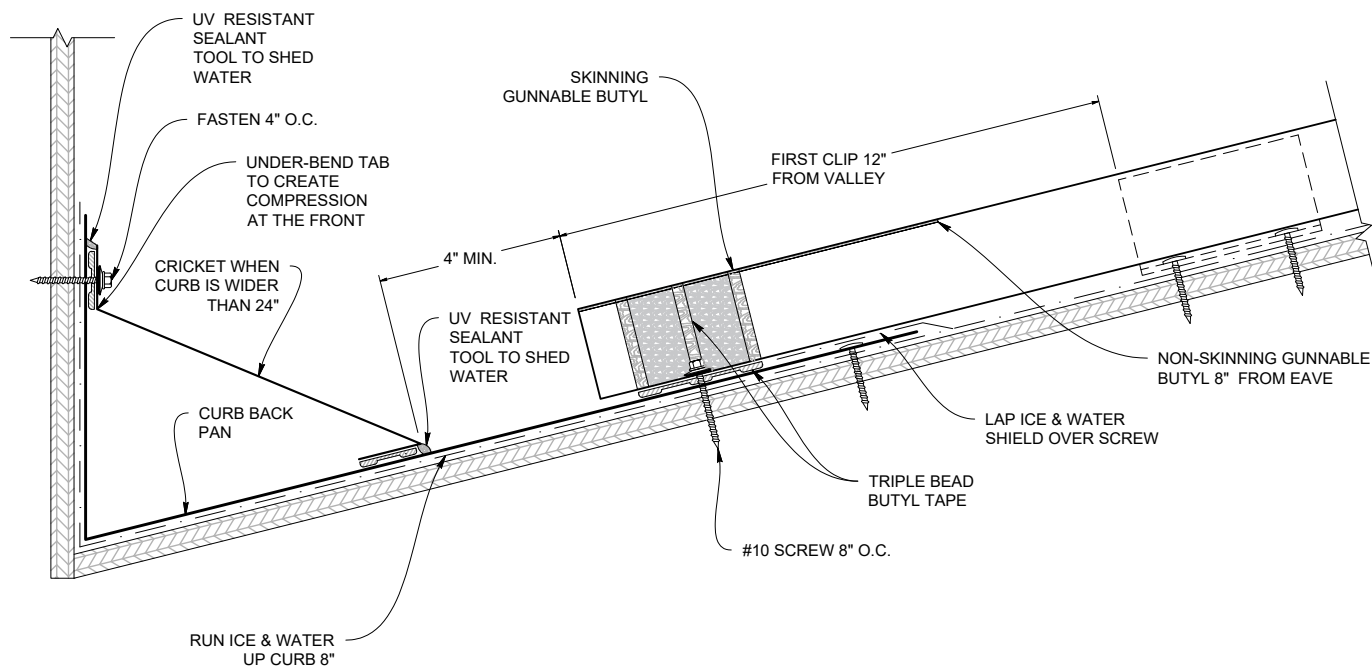
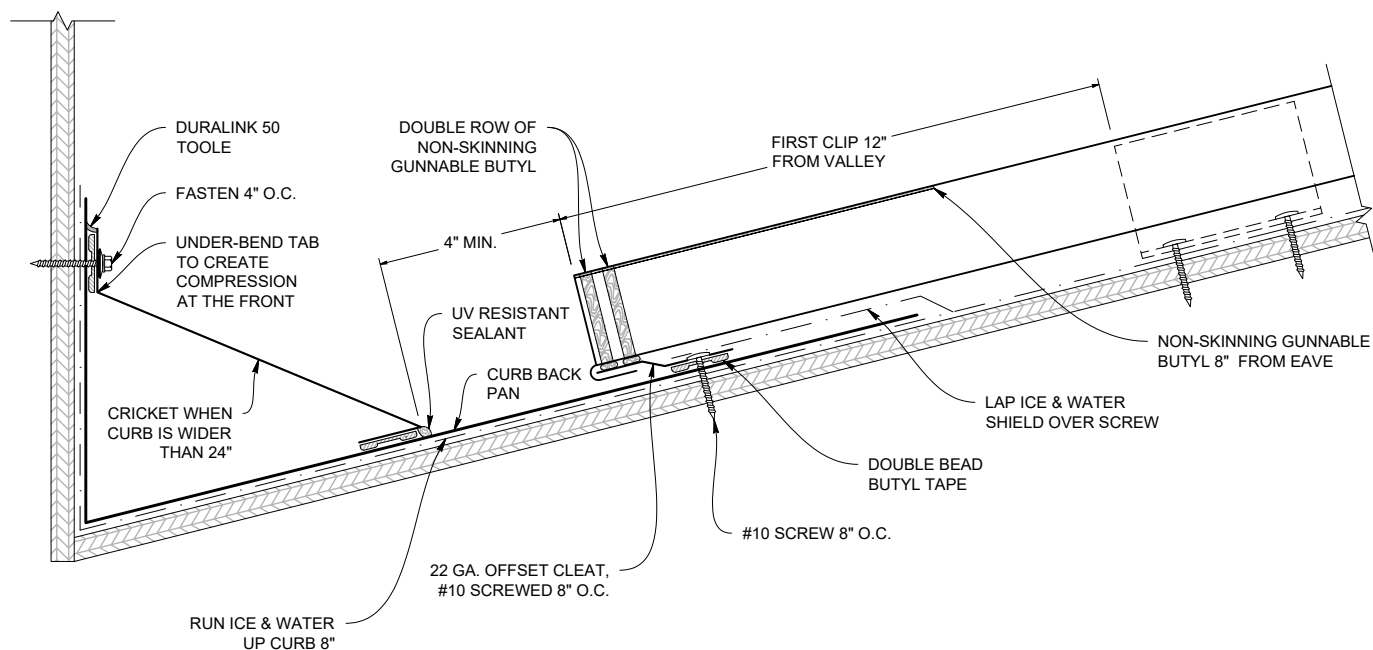

Note: All screws must be fastened into solid substrate.
Flashing must be lapped 4" with 3 rows of gunnable sealant.

EAVE TO GABLE TRANSITION

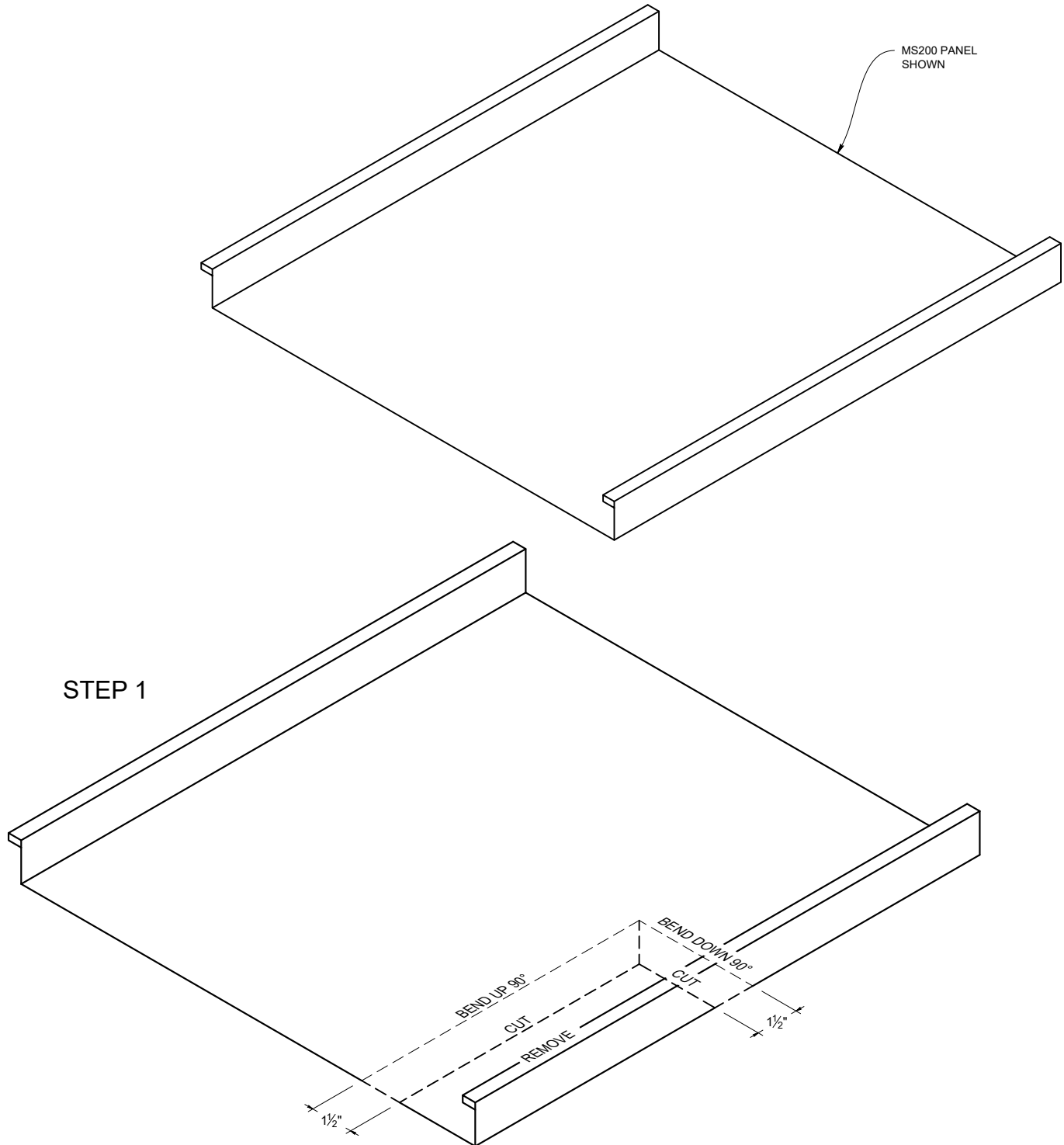

Note: All screws must be fastened into solid substrate.
Flashing must be lapped 4" with 3 rows of gunnable sealant.

Eave to Gable Transition

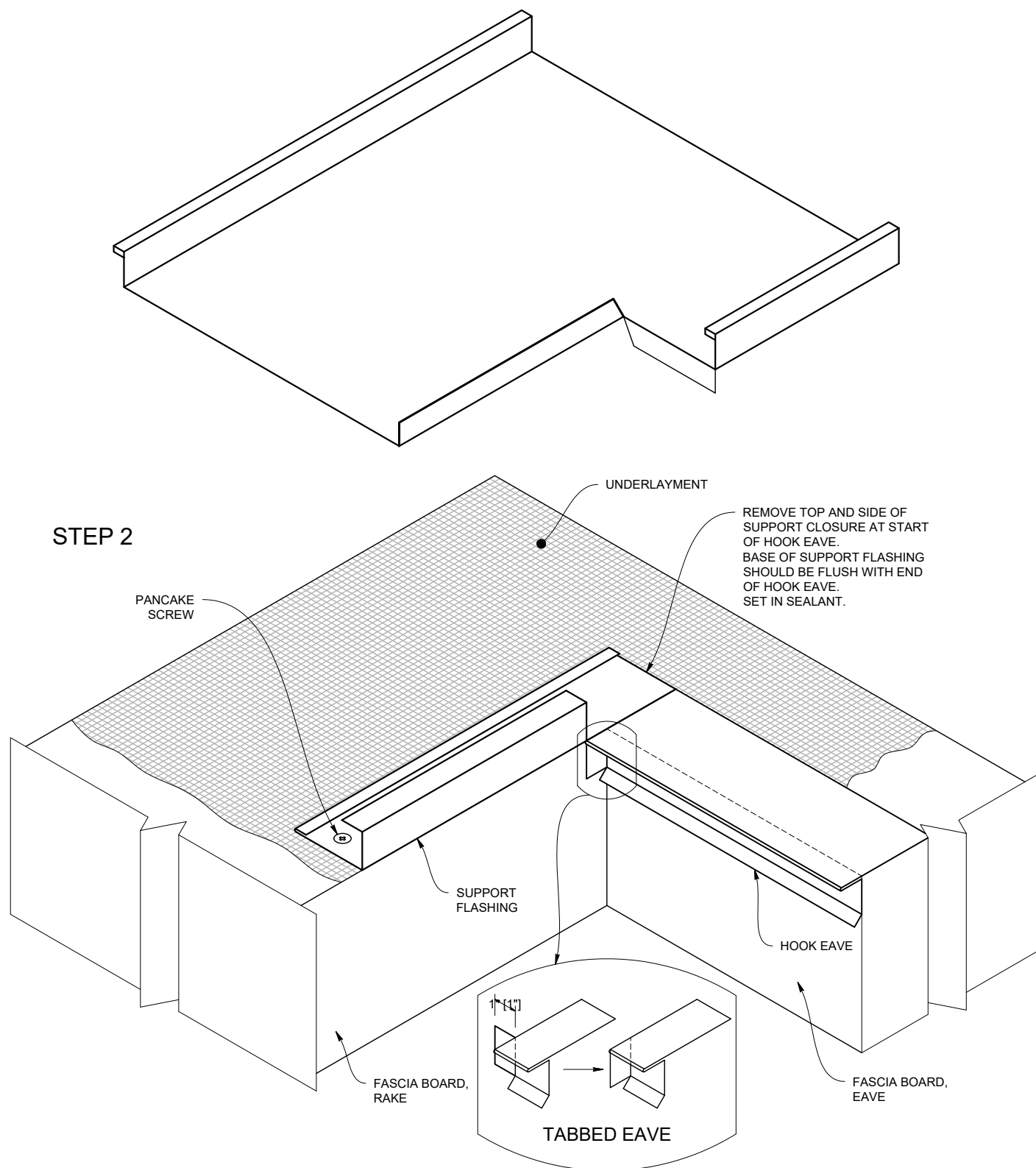

Note: All screws must be fastened into solid substrate.
Flashing must be lapped 4" with 3 rows of gunnable sealant.

Eave to Gable Transition

STEP 3

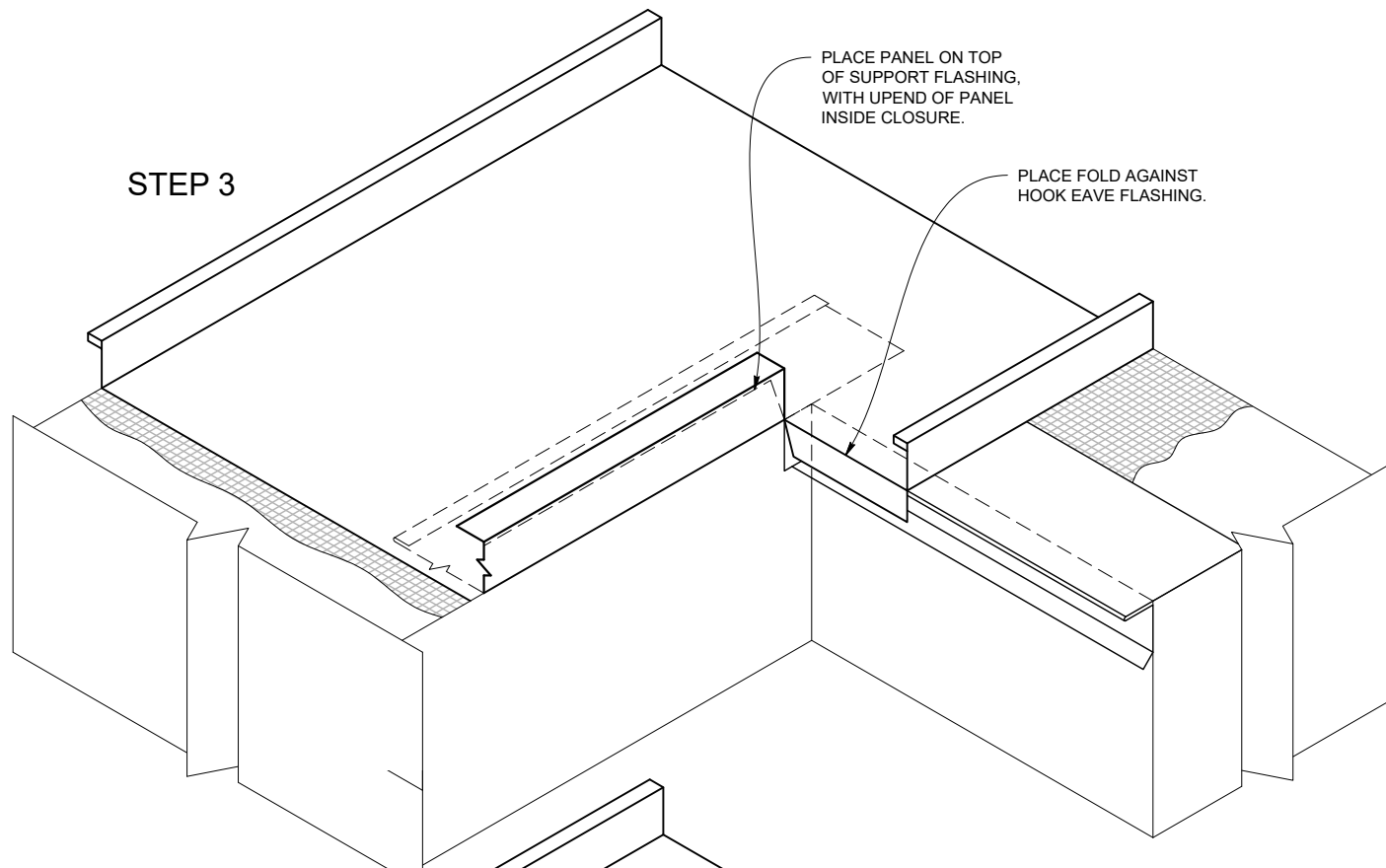

STEP 4

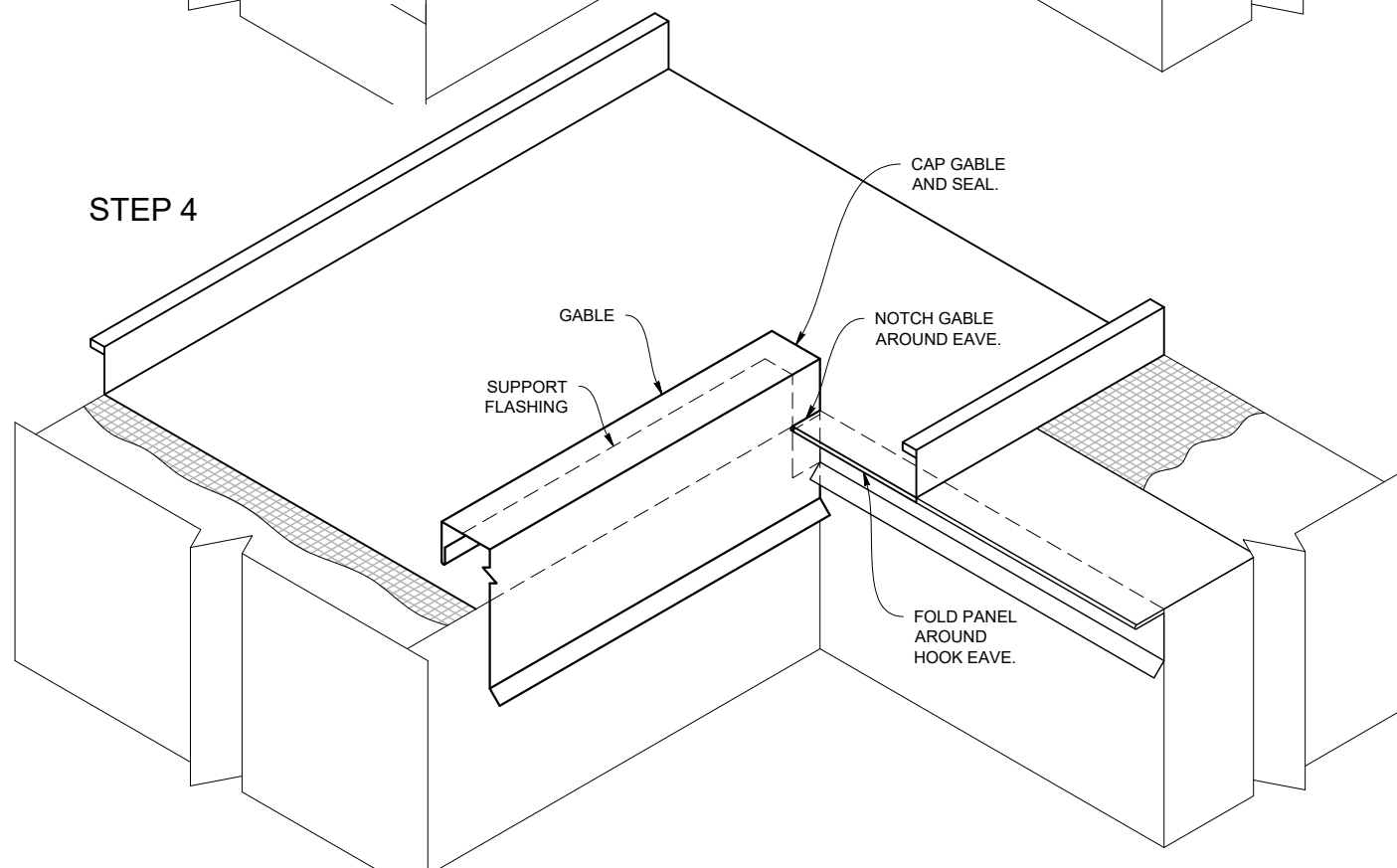

Note: All screws must be fastened into solid substrate.
Flashing must be lapped 4" with 3 rows of gunnable sealant.

Pipe Penetration - on Plate

FOR PIPES LOCATED 20' OR GREATER FROM PIN POINT

Allows panel and pipe flashing to move with temperature change.

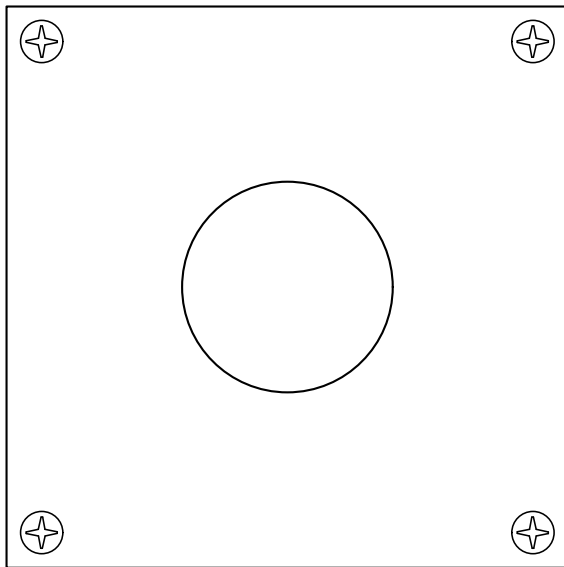
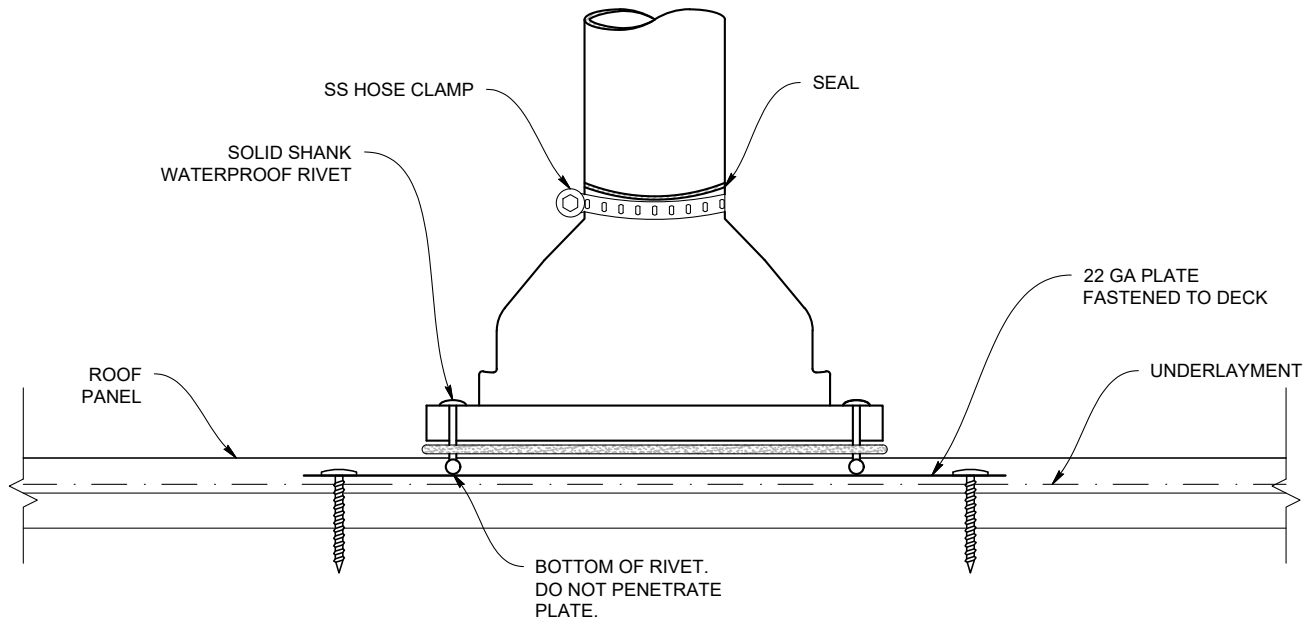

SINGLE 22 GAUGE PLATE

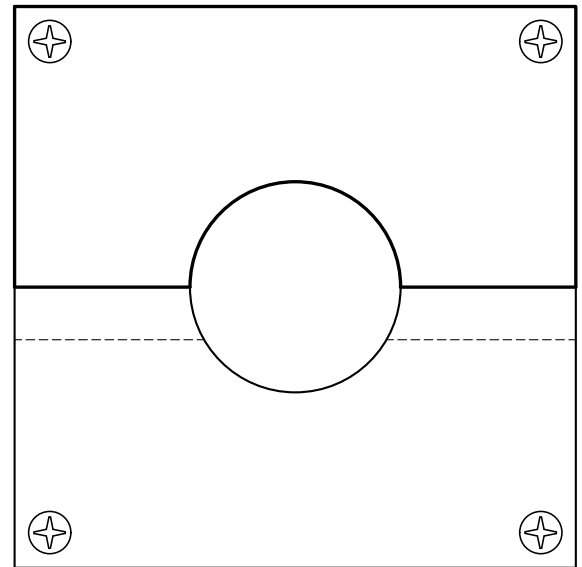

TWO OVERLAPPING 22 GAUGE PLATES

Note: All screws must be fastened into solid substrate.
Flashing must be lapped 4" with 3 rows of gunnable sealant.

Pipe Penetration - on Rib

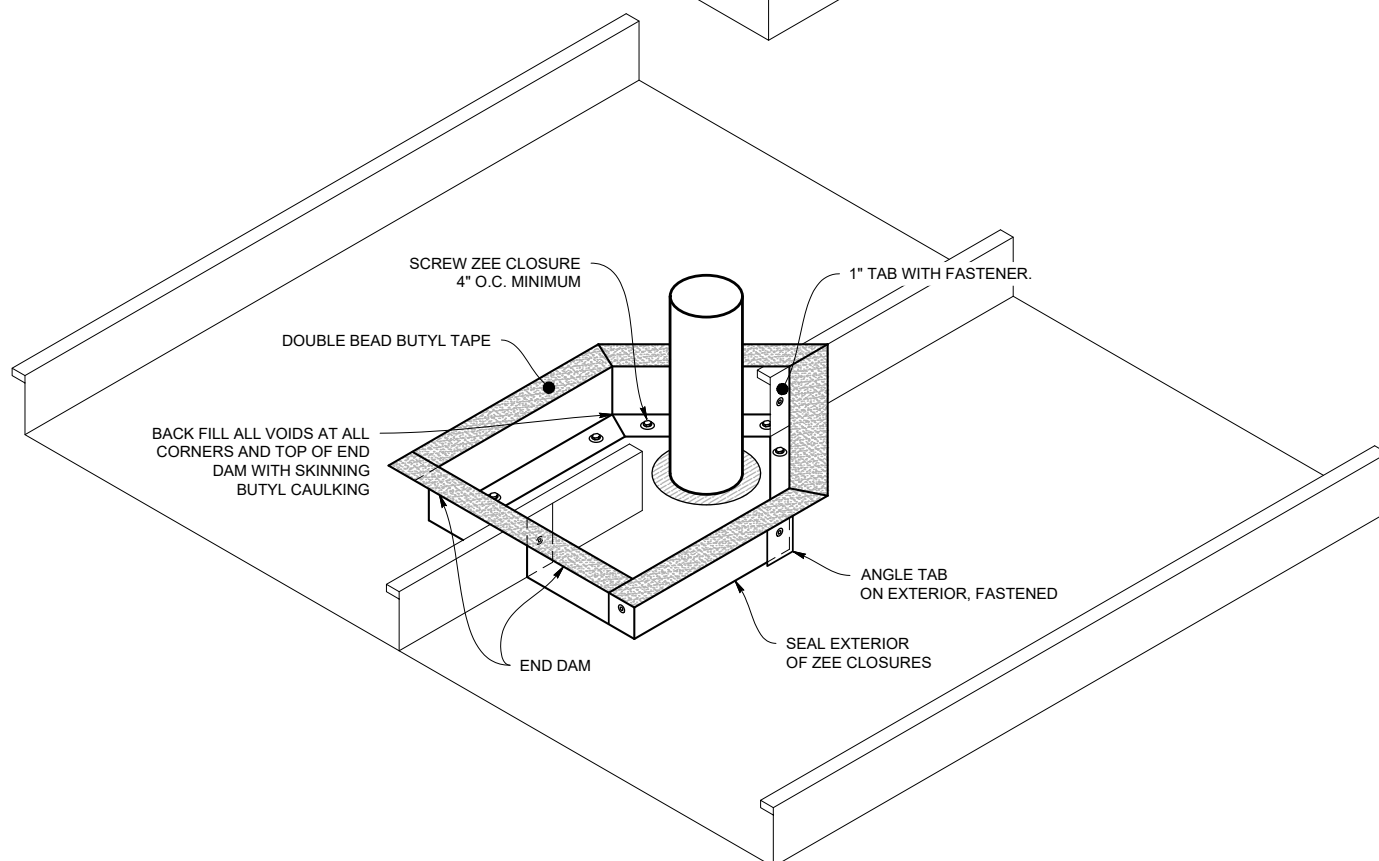
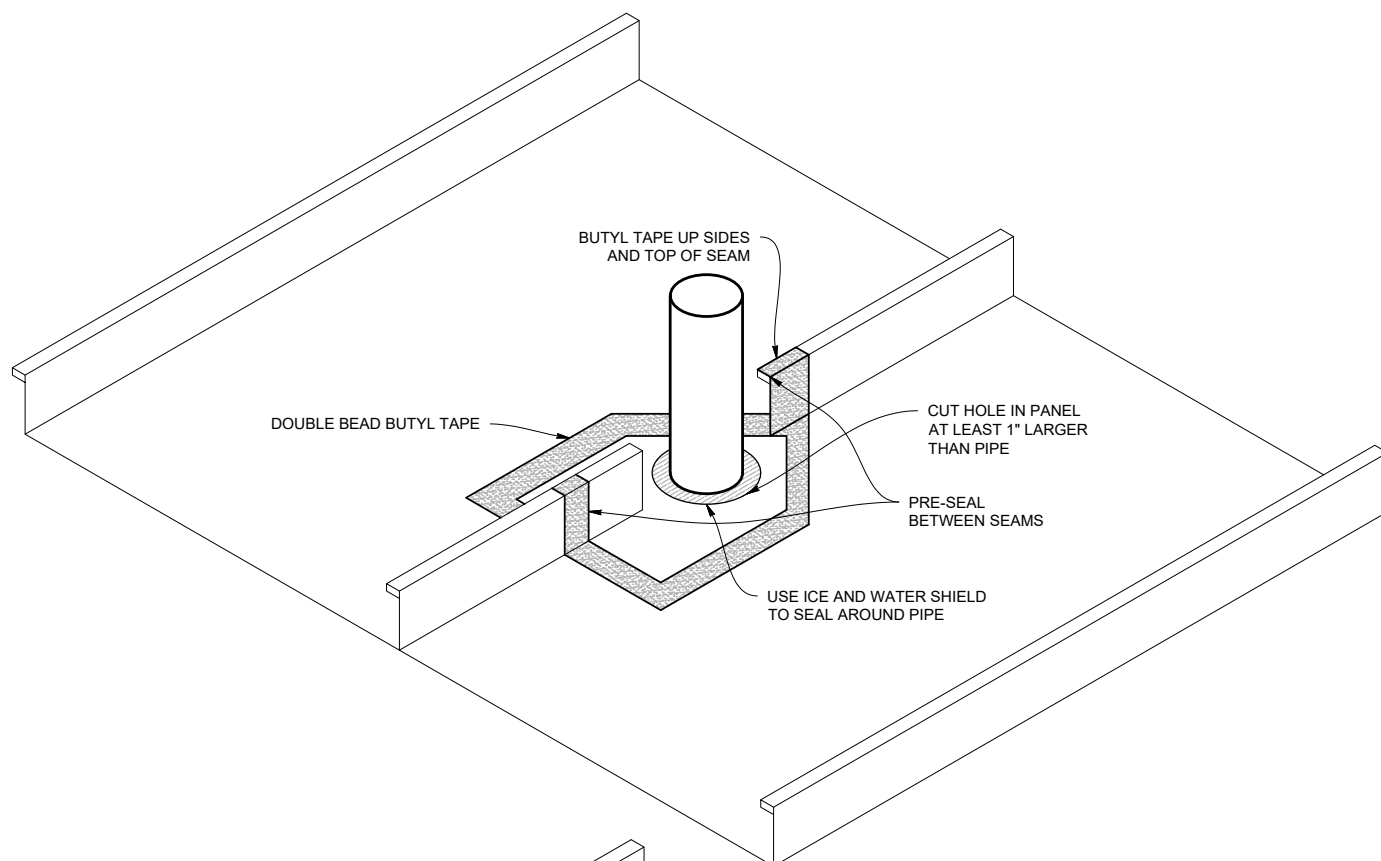

Note: All screws must be fastened into solid substrate.
Flashing must be lapped 4" with 3 rows of gunnable sealant.

Pipe Penetration - on Rib

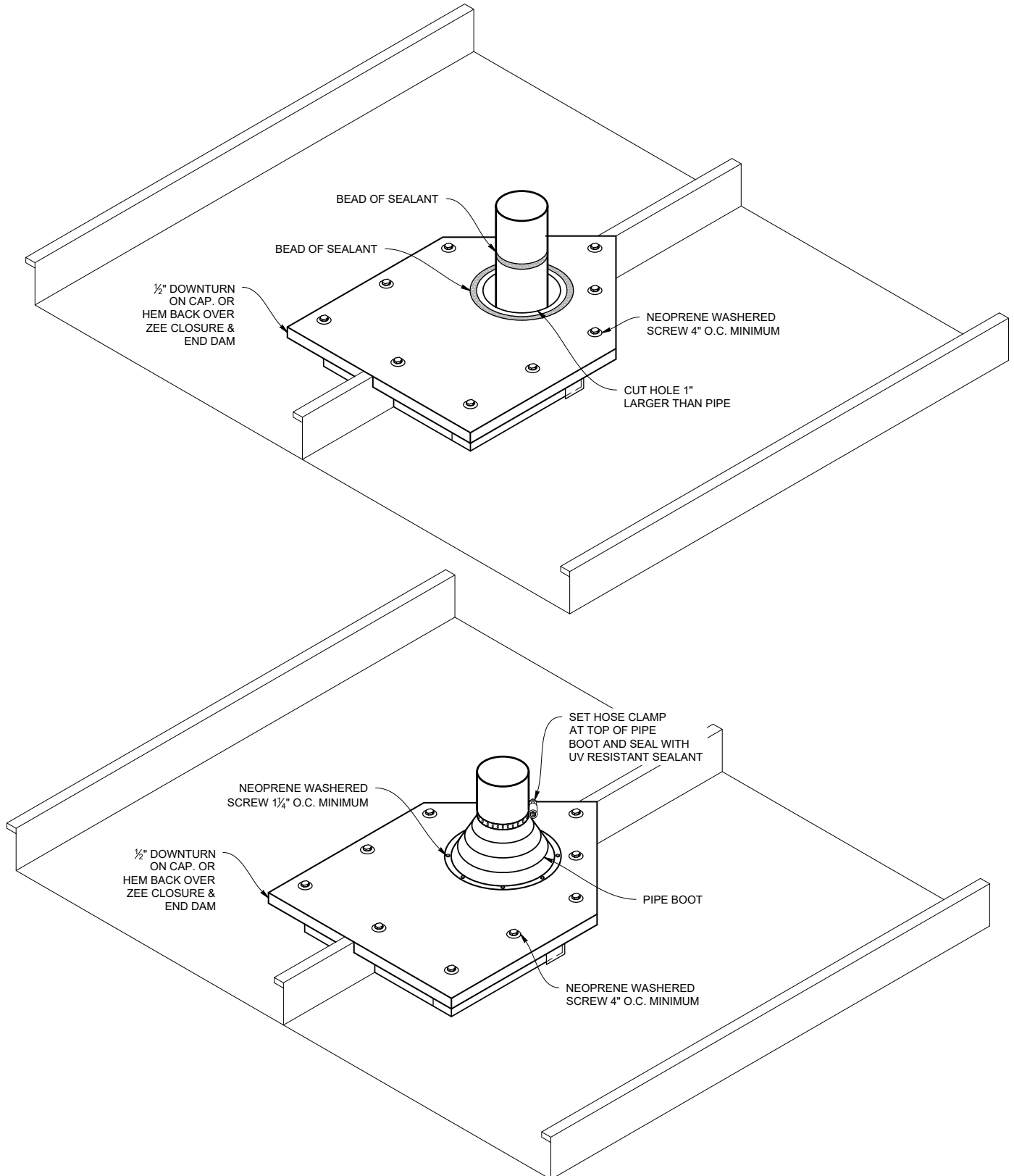

Note: All screws must be fastened into solid substrate.
Flashing must be lapped 4" with 3 rows of gunnable sealant.

Pipe Penetration - on Pan

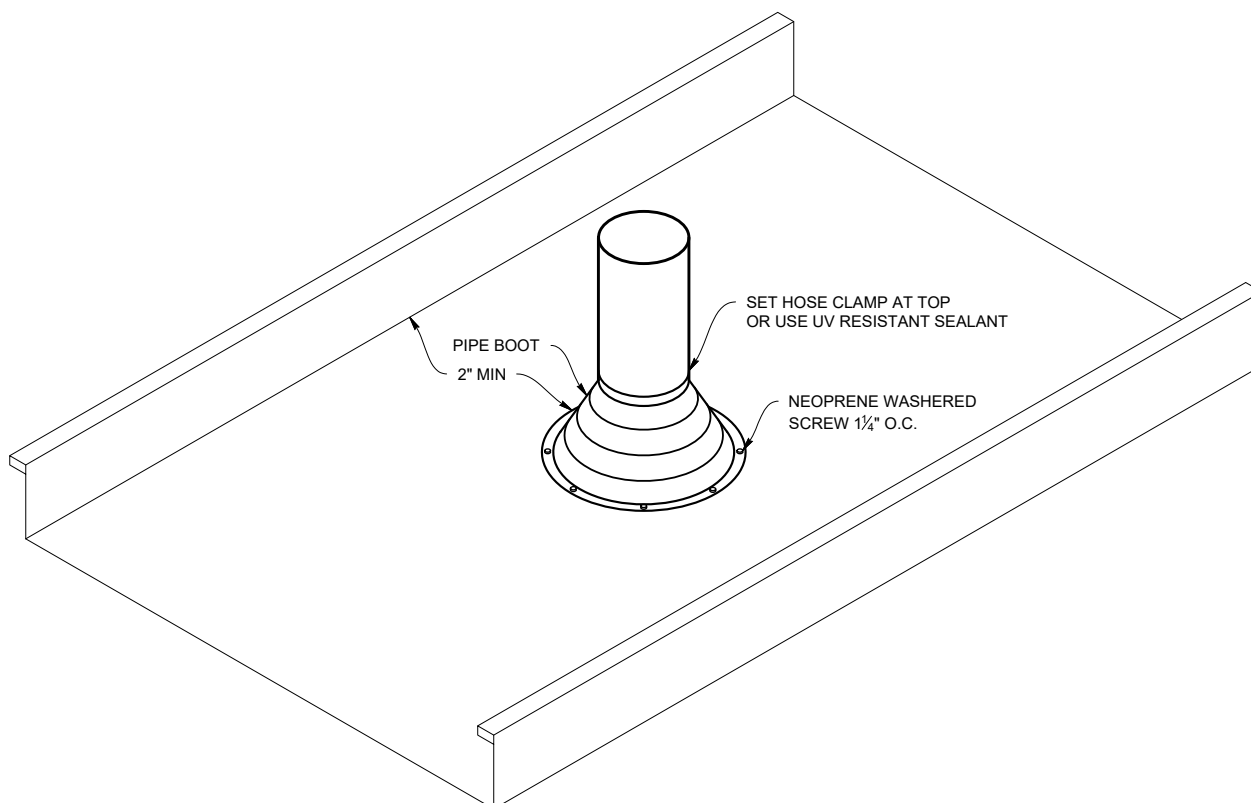
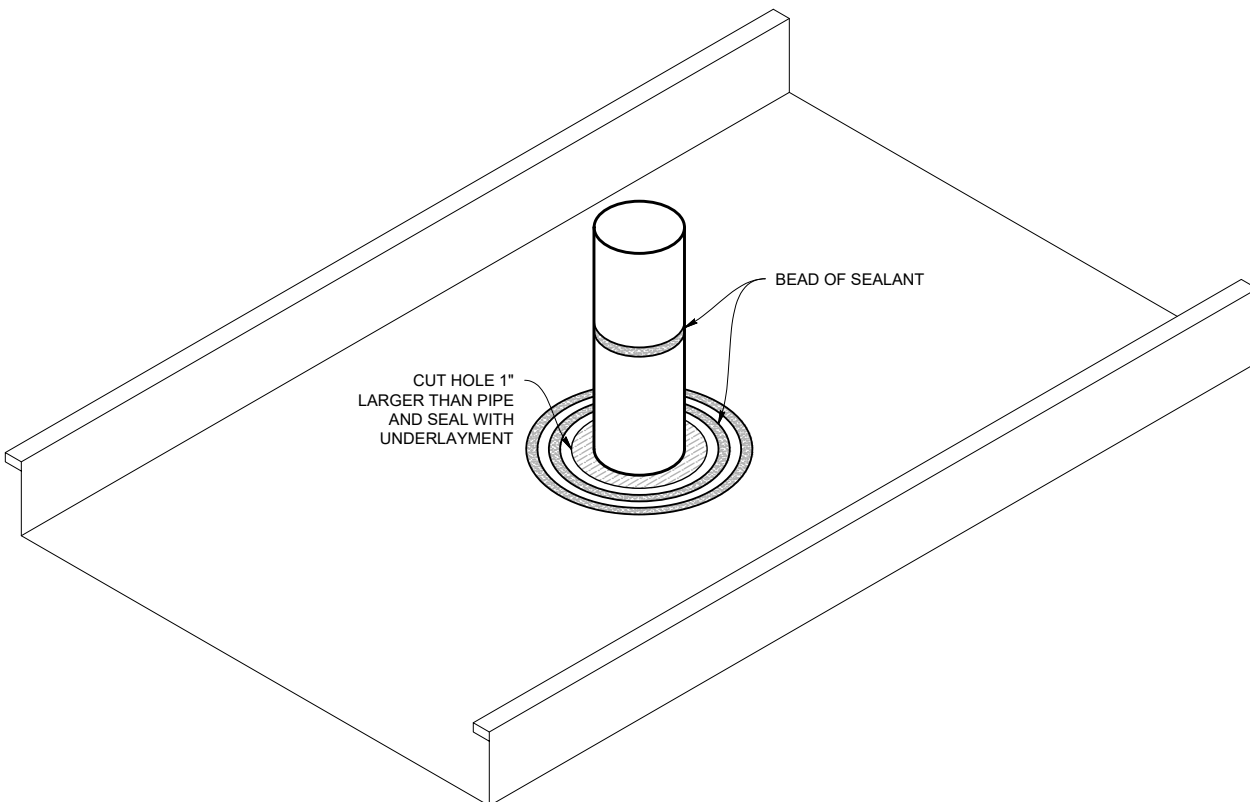

Note: All screws must be fastened into solid substrate.
Flashing must be lapped 4" with 3 rows of gunnable sealant.

MS-200™

Flashing and Details Selection
Flashing: 10' Standard



STANDARD EAVE (MS200ES)

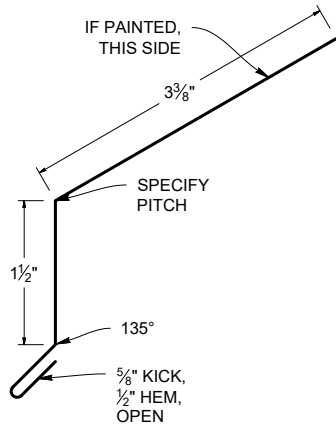

SCALE 1:2 S.O. 6" WEIGHT: 4.9 LBS.

HOOK EAVE (MS200EH)

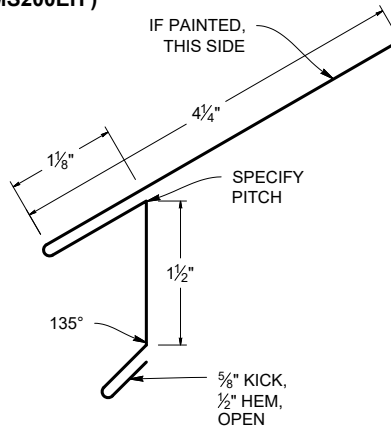

SCALE 1:2 S.O. 8" WEIGHT: 6.5 LBS.

OFFSET CLEAT (MS200OC)

NON-VISIBLE /
SUB-FLASHINGS ARE
NOT PROVIDED IN
SPECIFIC COLORS
UNLESS SPECIFIED

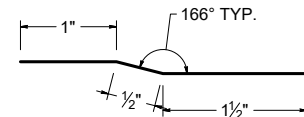

SCALE 1:2 S.O. 3" WEIGHT: 2.5 LBS.

GUTTER HANGER (AGH6)

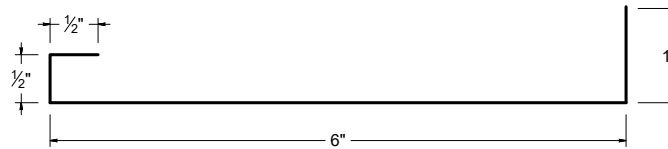

S.O. 0.5"

WEIGHT: 6.5 LBS.

SCALE 1:2

BOX GUTTER (MS200BG)

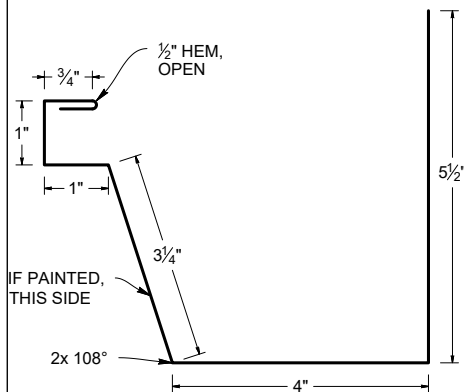

SCALE 1:3 S.O. 16" WEIGHT: 13.3 LBS.

STANDARD GABLE (MS200GS)

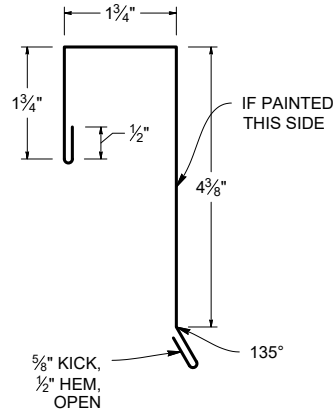

SCALE 1:3 S.O. 9.5" WEIGHT: 7.6 LBS.

GABLE CLEAT (MS200GC)

NON-VISIBLE /
SUB-FLASHINGS ARE
NOT PROVIDED IN
SPECIFIC COLORS
UNLESS SPECIFIED

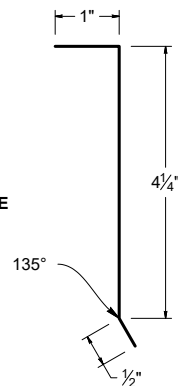

SCALE 1:3 S.O. 5.75" WEIGHT: 4.7 LBS.

ALTERNATE GABLE (MS200AG)

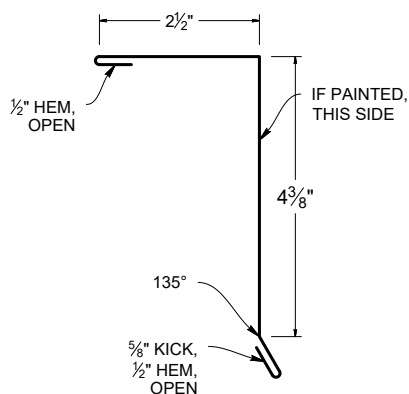

SCALE 1:3 S.O. 8.5" WEIGHT: 7 LBS.

ALT GABLE CLEAT (MS200AGC)

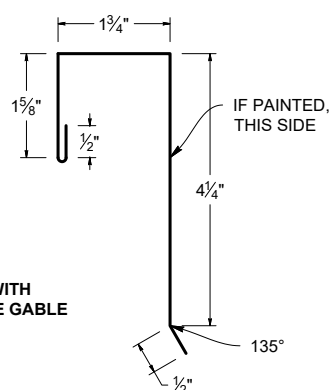

*FOR USE WITH
ALTERNATE GABLE
ONLY

SCALE 1:3 S.O. 8.625" WEIGHT: 4.7 LBS.

SUPPORT FLASHING (MS200SF)

NON-VISIBLE /
SUB-FLASHING ARE NOT
PROVIDE IN SPECIFIC
COLORS UNLESS
SPECIFIED

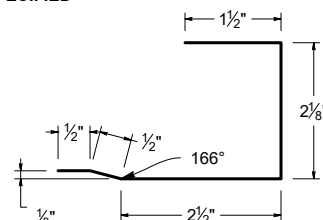

SCALE 1:3 S.O. 7.125" WEIGHT: 6 LBS.

VENTED RIDGE END CAP (MS200RECV)

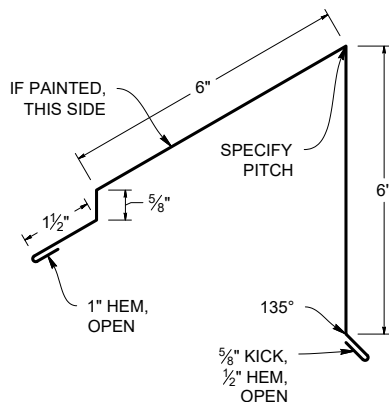

SCALE 1:4 S.O. 16.75" WEIGHT: 12.9 LBS.

RIDGE END CAP (MS200REC)

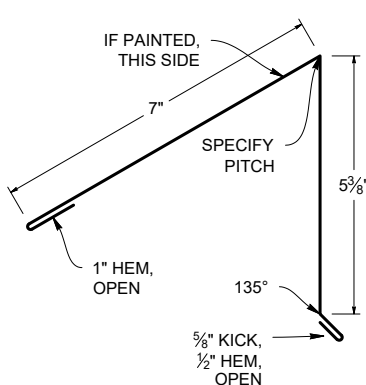

SCALE 1:4 S.O. 14.5" WEIGHT: 11.9 LBS.

WT VENTED PEAK FLASHING (MS200WTRECV)

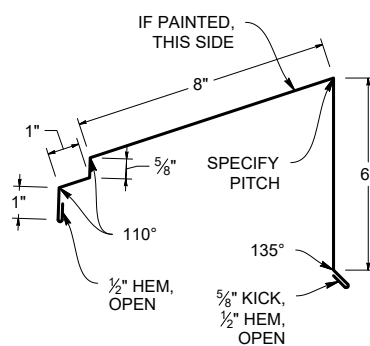

SCALE 1:6 S.O. 18.25" WEIGHT: 12.9 LBS.

VENTED RIDGE END CAP CLEAT (MS200VRECC)

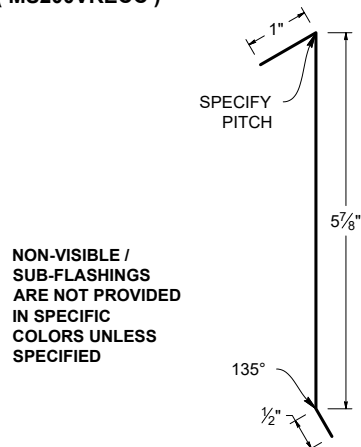

NON-VISIBLE /
SUB-FLASHINGS
ARE NOT PROVIDED
IN SPECIFIC
COLORS UNLESS
SPECIFIED

SCALE 1:3 S.O. 7.375" WEIGHT: 2.5 LBS.

RIDGE END CAP CLEAT (MS200RECC)

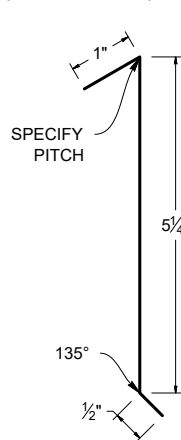

FOR USE WITH
MS200REC ONLY

NON-VISIBLE /
SUB-FLASHINGS ARE NOT
PROVIDE IN SPECIFIC
COLORS UNLESS
SPECIFIED

SCALE 1:3 S.O. 6.75" WEIGHT: 6 LBS.

MS-200™

Flashing and Details Selection
Flashing: 10' Standard



VALLEY WIDE FLASHING (MS200VFW)

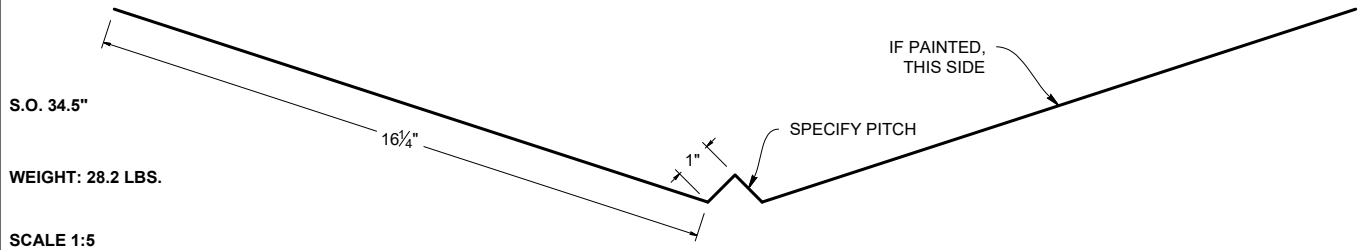

VALLEY FLASHING (MS200VF)

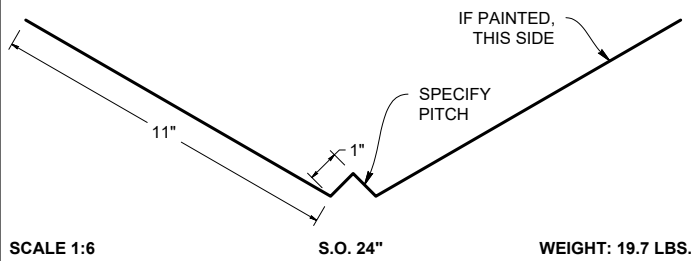

OFFSET CLEAT (MS200C)

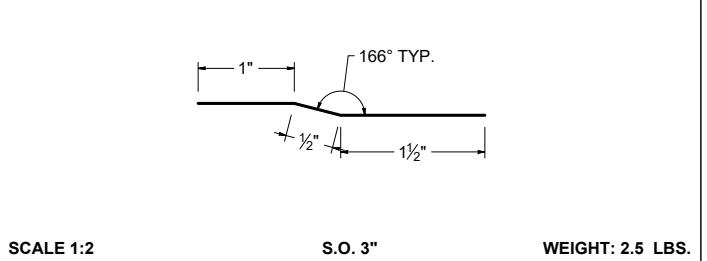

STANDARD RIDGE (MS200RS)

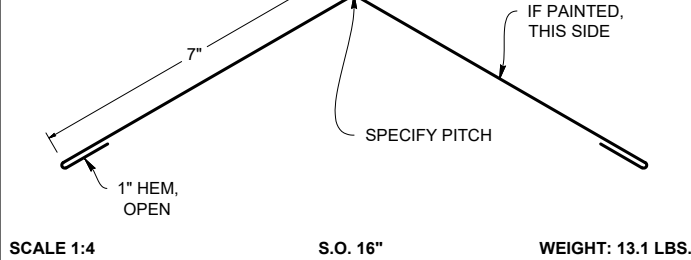

WT RIDGE FULL VENTED (MS200WTRFV)

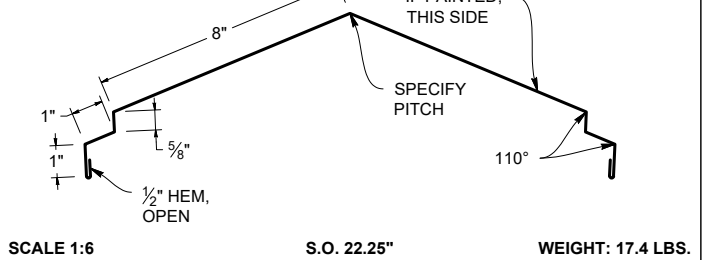

RIDGE FULL VENTED (MS200RFV)

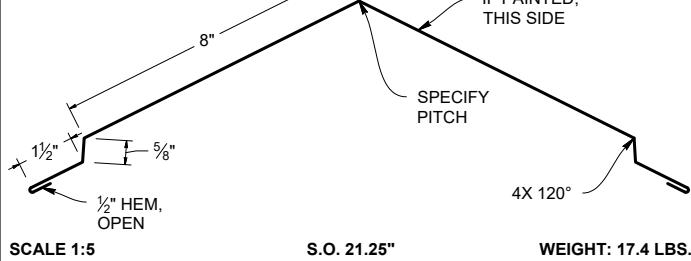

CURB SIDEWALL (MS200CSW)

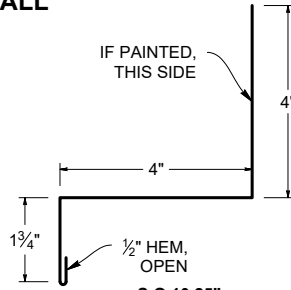

SCALE 1:4

S.O. 10.25"

WEIGHT: 8.2 LBS.

SIDEWALL (MS200SW)

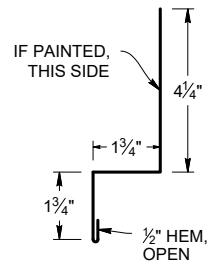

SCALE 1:5

S.O. 8.25"

WEIGHT: 6.6 LBS.

ENDWALL (MS200EW)

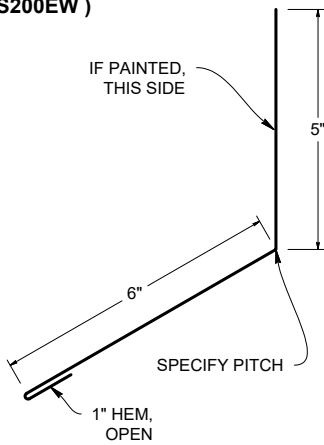

SCALE 1:4

S.O. 12"

WEIGHT: 9.8 LBS.

VENTED ENDWALL (MS200EWV)

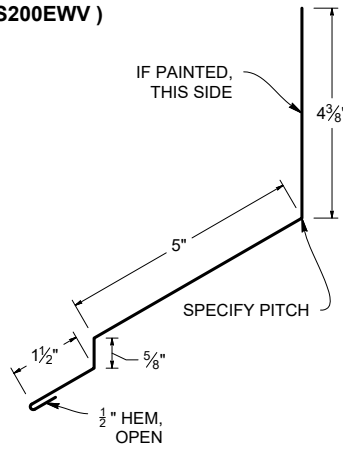

SCALE 1:4

S.O. 12"

WEIGHT: 12.6 LBS.

WT VENTED ENDWALL (MS200WTEWV)

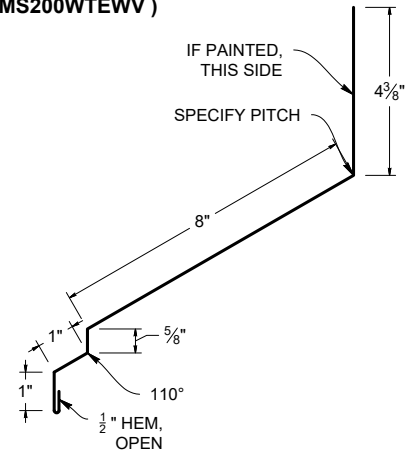

SCALE 1:5

S.O. 15.5"

WEIGHT: 10.7 LBS.

CURB ENDWALL (MS200CH)

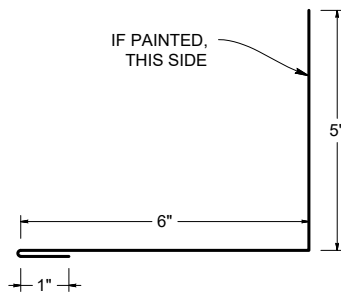

SCALE 1:4

S.O. 12"

WEIGHT: 9.8 LBS.

MS-200™

Flashing and Details Selection
Flashing: 10' Standard



BACK PAN (MS200PAN)

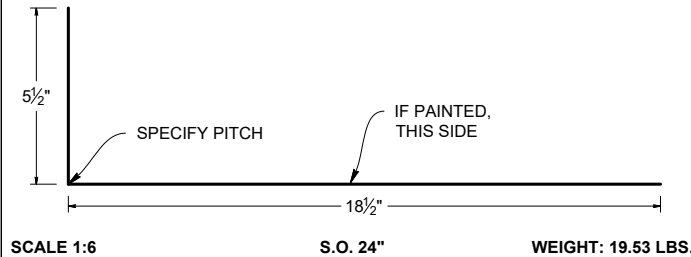

OFFSET CLEAT MS200OC

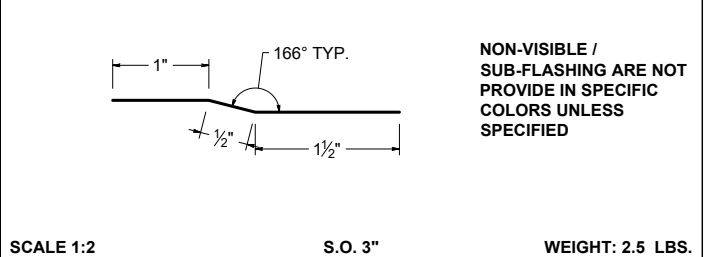

END DAM

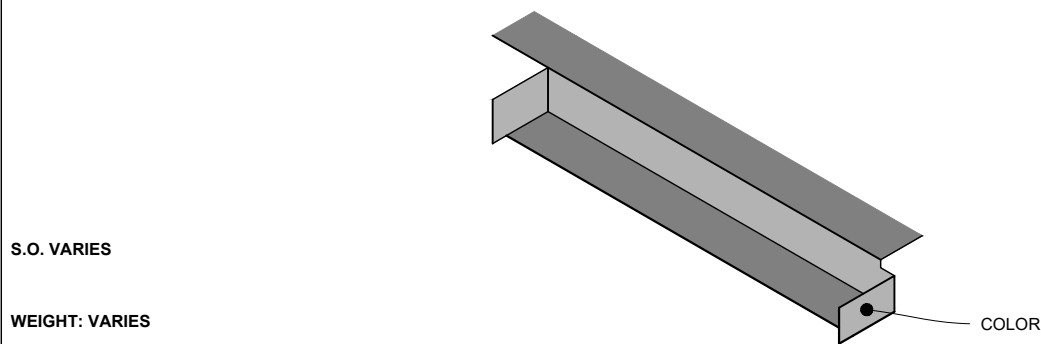

4" PERFORATED STRIP (MS200PS)

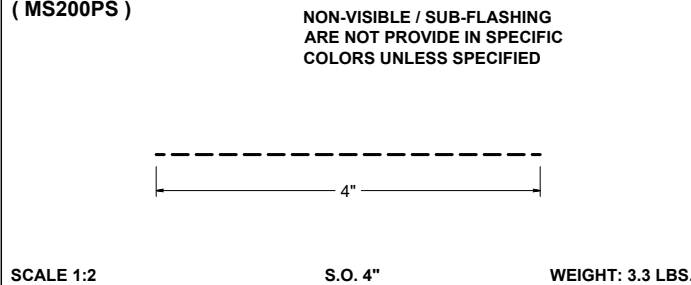

PERFORATED VENT DRIP (MS200PVD)

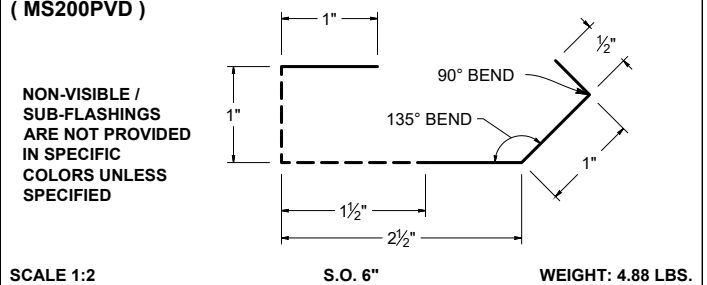

REGLET (MS200RF)

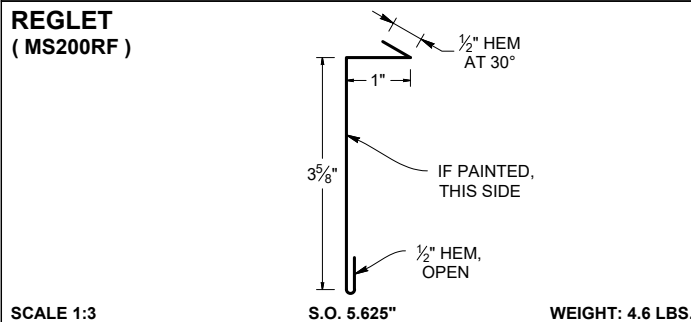

ZEE CLOSURE (MS200ZC)

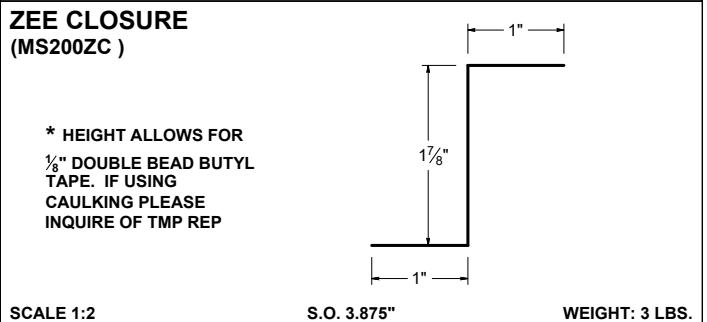

Custom Trim Order



Customer Name: _____ Job Name: _____

Gauge: _____ Color: _____ Status: ☐ Original ☐ New

Specify: ☐ Angles ☐ Color Side ☐ Dimensions ☐ Stretchout

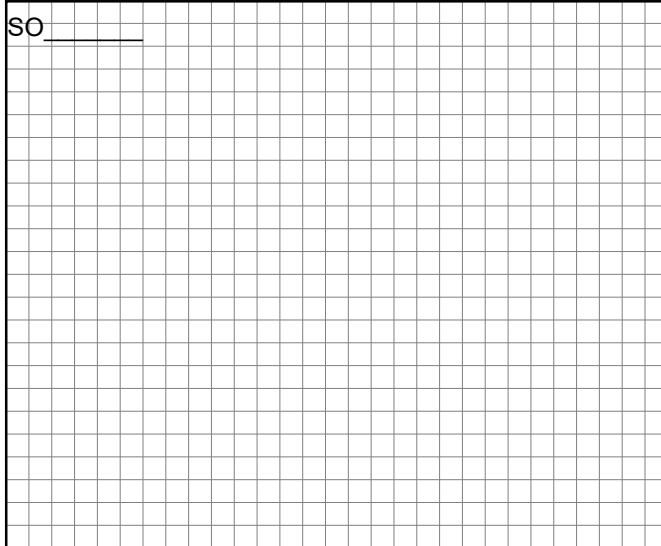
SO _____		
		
Dwg #: _____	Pitch: _____	# of Pieces: _____
Description: _____		
Hems: <input type="checkbox"/> Open <input type="checkbox"/> Closed <input type="checkbox"/> Slightly Open		

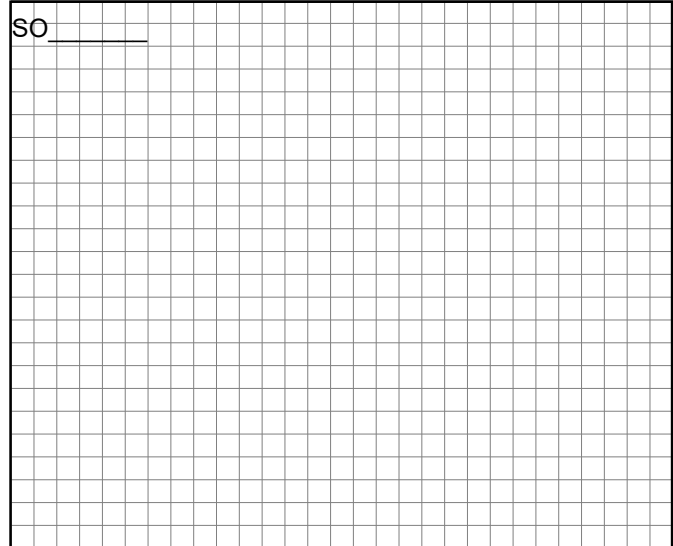
SO _____		
		
Dwg #: _____	Pitch: _____	# of Pieces: _____
Description: _____		
Hems: <input type="checkbox"/> Open <input type="checkbox"/> Closed <input type="checkbox"/> Slightly Open		

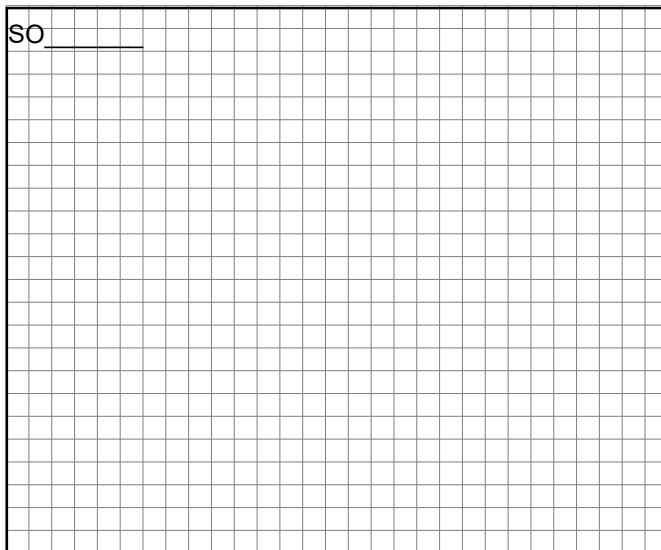
SO _____		
		
Dwg #: _____	Pitch: _____	# of Pieces: _____
Description: _____		
Hems: <input type="checkbox"/> Open <input type="checkbox"/> Closed <input type="checkbox"/> Slightly Open		

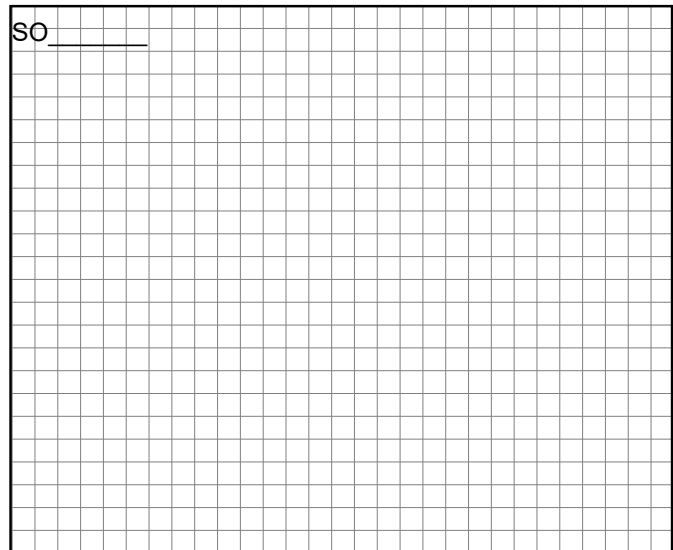
SO _____		
		
Dwg #: _____	Pitch: _____	# of Pieces: _____
Description: _____		
Hems: <input type="checkbox"/> Open <input type="checkbox"/> Closed <input type="checkbox"/> Slightly Open		

Please provide a drawing for each flashing with precise measurements and angles
Fax to: 503-581-6877

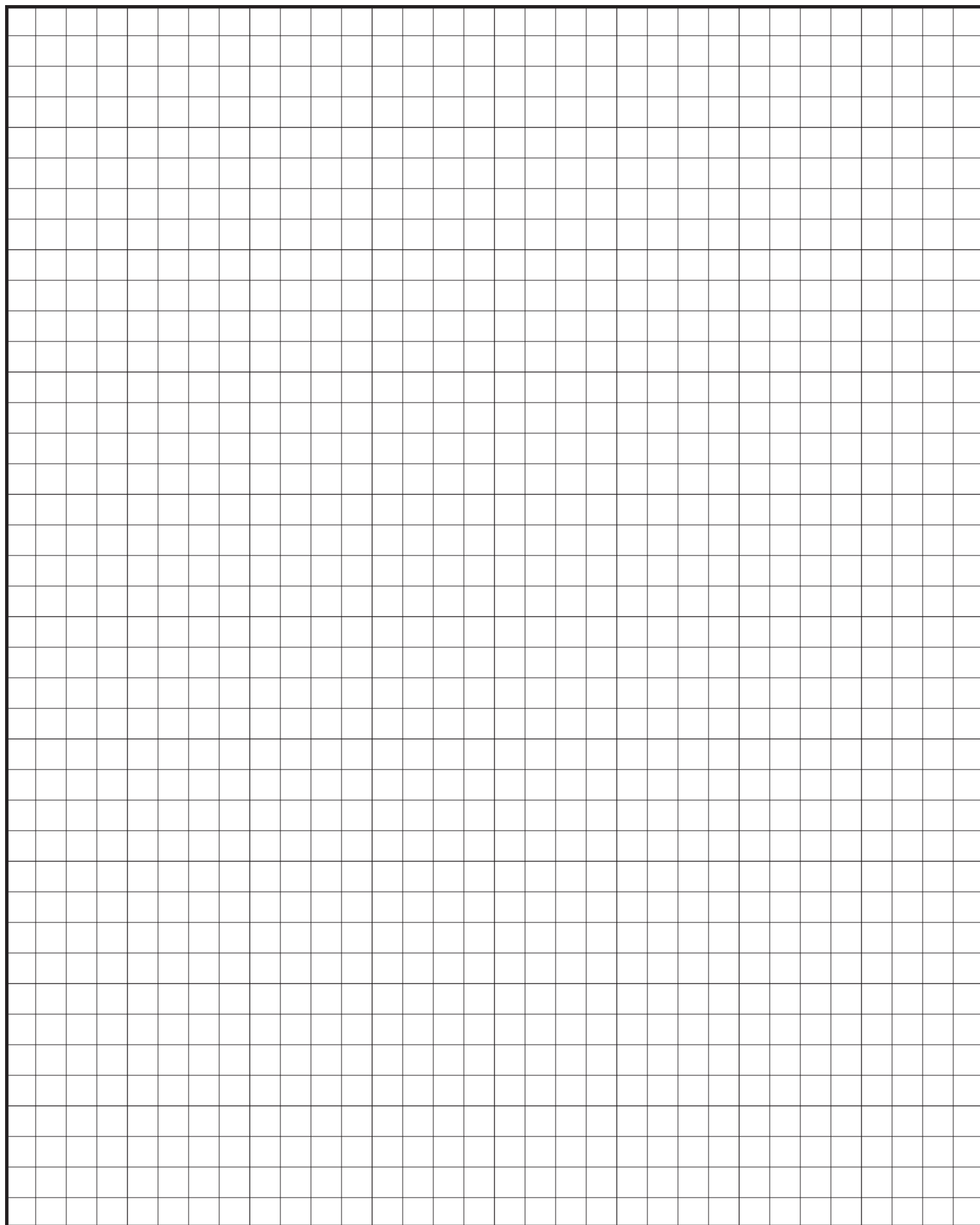

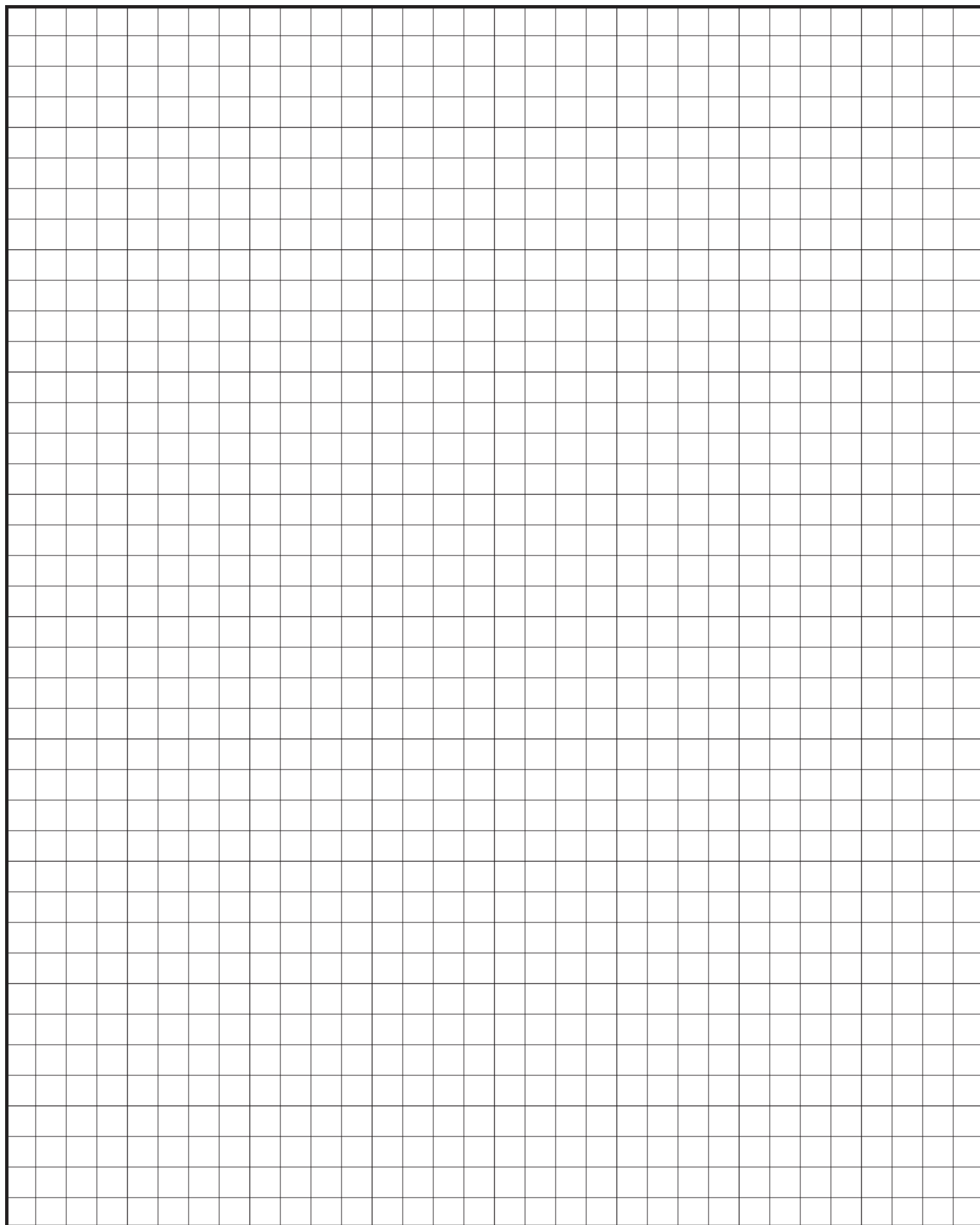



SALEM BRANCH

4566 Ridge Dr. NE
Salem, OR 97301

Office: 503-581-8338
Toll Free: 1-800-574-1388
Fax: 503-581-6877

SACRAMENTO BRANCH

5711 Perrin Ave
McClellan, CA 95652

Office: 916-318-8844
Toll Free: 1-800-574-1388
Fax: 916-993-4123

AUBURN BRANCH

2601 C St. SW
Auburn, WA 98001

Office: 206-900-9923
Toll Free: 1-800-574-1388
Fax: 253-804-3545

RIVERSIDE BRANCH

4880 Felspar St.
Riverside, CA 92509

Office: 323-407-7457
Toll Free: 1-877-504-1594

SPOKANE BRANCH

1010 N Nelson St
Spokane, WA 99202

Office: 509-535-8667
Toll Free: 800-238-4057
Fax: 509-535-8682